

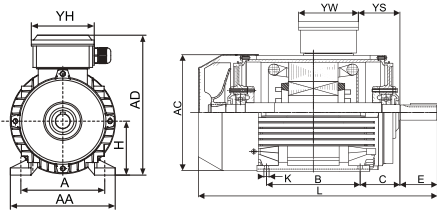

IEC YDS series Three Phase Asynchronous Motor

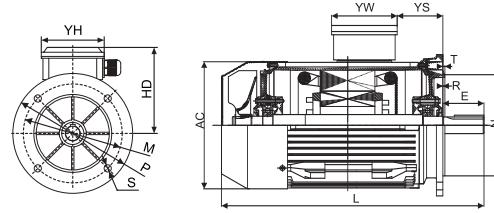

IM B3



IM B5

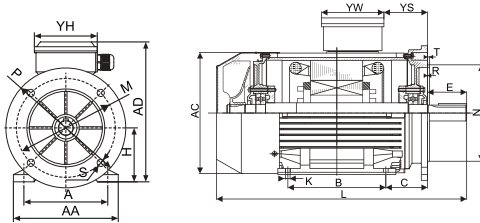

IM B35

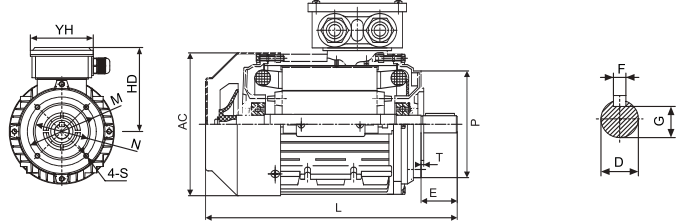

IM B14

Overall & Installation Dimensions

Frame	Poles	Foot Mounting				Shaft					General							
		H	A	B	C	D	E	F	G	K	AA	AD	HD	AC	L	YS	YW	YH
56	2,4,6	56	90	71	36	ø9	20	3	7.2	5.8x8.8	110	156	100	ø117	196	14	88	88
63	2,4,6	63	100	80	40	ø11	23	4	8.5	7x10	120	171	108	ø130	220	14	94	94
71	2,4,6	71	112	90	45	ø14	30	5	11	7x10	132	186	115	ø147	241(255)	20	94	94
80	2,4,6	80	125	100	50	ø19	40	6	15.5	ø9	160	220	140	ø158	280	16	97	97
90S/L	2,4,6	90	140	100/125	56	ø24	50	8	20	ø10	175	240	150	ø176	325/350	16	97	97
100	2,4,6	100	160	140	63	ø28	60	8	24	ø12	200	265	165	ø199	388	20	118	118
112	2,4,6	112	190	140	70	ø28	60	8	24	ø12	230	291	179	ø220	405	29	118	118
132S/M	2,4,6	132	216	140/178	89	ø38	80	10	33	ø12	255	332	200	ø259	467/505	29	118	118
160M/L	2,4,6	160	254	210/254	108	ø42	110	12	37	ø15	314	403	242	ø313	605/650	91	162	187
180M/L	2,4,6	180	279	241/279	121	ø48	110	14	42.5	ø15	348	439	259	ø360	687/725	160/180	162	187
200L	2,4,6	200	318	305	133	ø55	110	16	49	ø19	388	497	297	ø399	768	192	186	233
225S	4	225	356	286	149	ø60	140	18	53	ø19	436	553	328	ø465	814	190	186	233
225M	2	225	356	311	149	ø55	110	16	49	ø19	436	553	328	ø465	809	202	186	233
225M	4,6	225	356	311	149	ø60	140	18	53	ø19	436	553	328	ø465	839	202	186	233
250M	2	250	406	349	168	ø60	140	18	53	ø24	484	616	366	ø506	918	233	218	260
250M	4,6	250	406	349	168	ø65	140	18	58	ø24	484	616	366	ø506	918	233	218	260
280S/M	2	280	457	368/419	190	ø65	140	18	58	ø24	557	668	388	ø559	984/1035	265	218	260
280S/M	4,6	280	457	368/419	190	ø75	140	20	67.5	ø24	557	668	388	ø559	984/1035	265	218	260
315S	2	315	508	406	216	ø65	140	18	58	ø28	630	845	530	ø680	1205	130	280	320
315S	4,6	315	508	406	216	ø80	170	22	71	ø28	630	845	530	ø680	1235	130	280	320
315M/L	2	315	508	457/508	216	ø65	140	18	58	ø28	630	845	530	ø680	1355	130	280	320
315M/L	4,6	315	508	457/508	216	ø80	170	22	71	ø28	630	845	530	ø680	1385	130	280	320
355M/L	2	355	610	560/630	254	ø75	140	20	67.5	ø28	740	1010	655	ø820	1500	140	330	380
355M/L	4,6	355	610	560/630	254	ø100	210	28	90	ø28	740	1010	655	ø820	1570	140	330	380

Frame	Poles	Bearing		Cable Gland	B5						B14					
		Drive End	Non-Drive End		N	M	P	S	T	R	N	M	P	S	T	R
56	2,4,6	6201	6201	1-M16x1.5	ø80	ø100	ø120	ø7	3.0	0	ø50	ø65	ø80	M5	2.5	0
63	2,4,6	6201	6201	1-M16x1.5	ø95	ø115	ø140	ø10	3.0	0	ø60	ø75	ø90	M5	2.5	0
71	2,4,6	6202	6202	1-M20x1.5	ø110	ø130	ø160	ø10	3.5	0	ø70	ø85	ø105	M6	2.5	0
80	2,4,6	6204ZZ	6204ZZ	1-M20x1.5	ø130	ø165	ø198	4-ø12	3.5	0	ø80	ø100	ø118	M6	3	0
90S/L	2,4,6	6205ZZ	6205ZZ	1-M20x1.5	ø130	ø165	ø198	4-ø12	3.5	0	ø95	ø115	ø138	M8	3	0
100	2,4,6	6206ZZ	6206ZZ	1-M20x1.5	ø180	ø215	ø250	4-ø15	4	0	ø110	ø130	ø158	M8	3.5	0
112	2,4,6	6306ZZ	6306ZZ	2-M25x1.5	ø180	ø215	ø250	4-ø15	4	0	ø110	ø130	ø158	M8	3.5	0
132S/M	2,4,6	6308ZZ	6308ZZ	2-M25x1.5	ø230	ø265	ø300	4-ø15	4	0	ø130	ø165	ø198	M10	3.5	0
160M/L	2,4,6	6309C3	6309C3	2-M32x1.5	ø250	ø300	ø350	4-ø19	5	0	-	-	-	-	-	0
180M/L	2,4,6	6311C3	6311C3	2-M32x1.5	ø250	ø300	ø350	4-ø19	5	0	-	-	-	-	-	0
200L	2,4,6	6312C3	6312C3	2-M40x1.5	ø300	ø350	ø400	4-ø19	5	0	-	-	-	-	-	0
225S	4	6313C3	6313C3	2-M50x1.5	ø350	ø400	ø450	8-ø19	5	0	-	-	-	-	-	0
225M	2	6313C3	6313C3	2-M50x1.5	ø350	ø400	ø450	8-ø19	5	0	-	-	-	-	-	0
225M	4,6	6313C3	6313C3	2-M50x1.5	ø350	ø400	ø450	8-ø19	5	0	-	-	-	-	-	0
250M	2	6314C3	6314C3	2-M50x1.5	ø400	ø500	ø550	8-ø19	5	0	-	-	-	-	-	0
250M	4,6	6314C3	6314C3	2-M50x1.5	ø400	ø500	ø550	8-ø19	5	0	-	-	-	-	-	0
280S/M	2	6316C3	6316C3	2-M50x1.5	ø400	ø500	ø550	8-ø19	5	0	-	-	-	-	-	0
280S/M	4,6	6316C3	6316C3	2-M50x1.5	ø400	ø500	ø550	8-ø19	5	0	-	-	-	-	-	0
315S/M/L	2	6317C3	6317C3	2-M63x1.5	ø550	ø600	ø660	8-ø24	6	0	-	-	-	-	-	0
315S/M/L	4,6	NU319	6319C3	2-M63x1.5	ø550	ø600	ø660	8-ø24	6	0	-	-	-	-	-	0
355M/L	2	6319C3	6319C3	2-M63x1.5	ø680	ø740	ø800	8-ø24	6	0	-	-	-	-	-	0
355M/L	4,6	NU322	6322C3	2-M63x1.5	ø680	ø740	ø800	8-ø24	6	0	-	-	-	-	-	0



IEC Standard

YDS series Three Phase Asynchronous Motor



IE2 YDS2AF



IE2 YDS2A

Features:

- Energy savings, high efficiency
- High starting torque, lower starting current
- Versatile and easy to modify design adapts to a variety of applications
- Removable feet
- Option of terminal box location (top, left or right)
- Option of IE2, IE3
- Contained total length is the same as or shorter than the current market standard.
- Full use of the magnetization properties of cold rolled silicon steel in which the stator laminations are magnetized evenly to reduce temperature rise of the winding.

Application:

- Pumps
- Waster water treatment plants
- Air compressors, fans
- Gear reducers and power transmission
- Pulp and paper mills
- Steel mill
- Conveyors, elevators
- Material handling equipment
- Agricultural application
- Mining equipment
- Hydraulic equipment

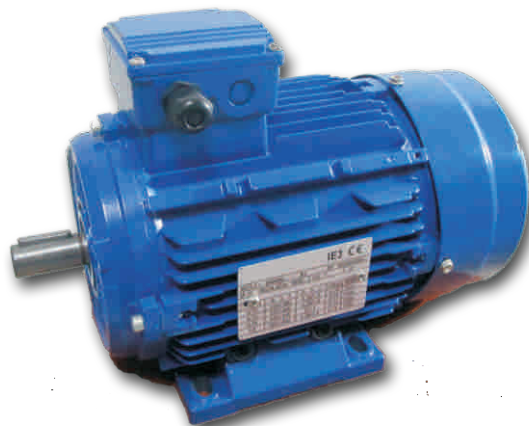

IE3 YDS3A



YDS1A Series IE1 Efficiency Motors Technical Data (at 50Hz)

Model	Output kW	Current (A)			Current (A)			Current (A)			Speed (r/min)	Eff (%)	Power Factor	Tst/Tn (Times)	Tmax/Tn (Times)	Tmin/Tn (Times)	Ist/In (Times)	Noise dB(A)	N.W (kgs)	Moment of Inertia (kg*m2)
		220V	380V	660V	230V	400V	690V	240V	415V	720V										
YDS1A 56A2	0.09	0.62	0.36	0.21	0.59	0.34	0.20	0.57	0.33	0.19	2710	53.0	0.72	2.2	2.3	2	4	58	2.8	0.000102
YDS1A 56B2	0.12	0.72	0.42	0.24	0.68	0.39	0.23	0.66	0.38	0.22	2700	61.0	0.72	2.2	2.3	2	4	58	3.2	0.000128
YDS1A 56C2	0.18	1.00	0.58	0.33	0.95	0.55	0.32	0.92	0.53	0.31	2710	63.0	0.75	2.2	2.4	1.6	6	61	3.5	0.000142
YDS1A 63A2	0.18	1.00	0.58	0.33	0.95	0.55	0.32	0.92	0.53	0.31	2710	63.0	0.75	2.2	2.4	1.6	6	61	3.7	0.00015
YDS1A 63B2	0.25	1.30	0.75	0.43	1.23	0.71	0.41	1.19	0.69	0.40	2710	65.0	0.78	2.2	2.4	1.6	6	61	4.2	0.000171
YDS1A 63C2	0.37	1.92	1.11	0.64	1.82	1.05	0.61	1.76	1.02	0.59	2710	65.0	0.78	2.2	2.4	1.6	6	62	4.7	0.000203
YDS1A 71A2	0.37	1.76	1.02	0.59	1.67	0.97	0.56	1.61	0.93	0.54	2730	70.0	0.79	2.2	2.4	1.6	6	64	5.34	0.000314
YDS1A 71B2	0.55	2.58	1.49	0.86	2.45	1.42	0.82	2.36	1.36	0.79	2760	71.0	0.79	2.2	2.4	1.6	6	64	6.14	0.000384
YDS1A 71C2	0.75	3.34	1.93	1.11	3.18	1.83	1.06	3.06	1.77	1.02	2730	72.0	0.82	2.2	2.4	1.5	6	65	7.1	0.000475
YDS1A 80A2	0.75	3.42	1.98	1.14	3.25	1.88	1.08	3.13	1.81	1.04	2870	72.1	0.8	2.1	2.5	1.5	5.7	67	8.15	0.0009
YDS1A 80B2	1.1	4.41	2.55	1.47	4.19	2.42	1.40	4.04	2.33	1.35	2870	79.0	0.83	2.6	2.8	1.8	6.5	67	9.7	0.001124
YDS1A 80C2	1.5	5.87	3.39	1.96	5.58	3.22	1.86	5.38	3.10	1.79	2870	81.0	0.83	2.7	2.8	1.8	6.8	70	11.2	0.001351
YDS1A 90S2	1.5	5.94	3.43	1.98	5.65	3.26	1.88	5.44	3.14	1.81	2880	80.0	0.83	2.3	2.8	1.4	6.6	72	12.3	0.001856
YDS1A 90LA2	2.2	8.25	4.77	2.75	7.84	4.53	2.61	7.56	4.36	2.52	2880	83.5	0.84	2.6	2.7	1.8	7.1	72	14.9	0.002306
YDS1A 90LB2	3.0	10.80	6.24	3.60	10.30	5.92	3.42	9.89	5.71	3.30	2900	86.0	0.85	2.9	3	1.9	8.1	74	17.4	0.002966
YDS1A 100LA2	3.0	11.3	6.5	3.8	10.8	6.2	3.6	10.4	6.0	3.5	2900	83.0	0.84	2.7	3.2	2.1	7.7	76	20.1	0.003776
YDS1A 100LB2	4.0	15.0	8.7	5.0	14.3	8.2	4.8	13.7	7.9	4.6	2890	84.5	0.83	3.1	3.6	2.8	8.1	77	23	0.004664
YDS1A 100LC2	5.5	18.7	10.8	6.2	17.8	10.3	5.9	17.1	9.9	5.7	2900	88.0	0.88	3.3	3.6	2.5	10.1	78	26	0.005907
YDS1A 112MA2	4.0	14.2	8.2	4.8	13.5	7.8	4.5	13.0	7.5	4.3	2910	85.0	0.87	2.8	3.6	1.7	9.2	77	26.3	0.006311
YDS1A 112MB2	5.5	19.0	11.0	6.3	18.1	10.4	6.0	17.4	10.1	5.8	2900	86.5	0.88	3	3.8	2.2	9.8	78	31.2	0.007796
YDS1A 112MC2	7.5	25.8	14.9	8.6	24.5	14.1	8.2	23.6	13.6	7.9	2910	88.0	0.87	3.8	4.2	2.7	10.3	80	37	0.009833
YDS1A 132SA2	5.5	19.7	11.4	6.6	18.7	10.8	6.2	18.0	10.4	6.0	2890	84.4	0.87	2.2	2.8	2.2	6.8	80	37.6	0.012058
YDS1A 132SB2	7.5	25.8	14.9	8.6	24.5	14.1	8.2	23.6	13.6	7.9	2890	88.0	0.87	2.7	3.2	2.5	8.2	80	43	0.015212
YDS1A 132MA2	9.2	30.6	17.6	10.2	29.0	16.8	9.7	28.0	16.2	9.3	2910	88.0	0.9	3.1	3.8	1.7	9.7	81	48.4	0.017834
YDS1A 132MB2	11.0	36.5	21.1	12.2	34.7	20.0	11.6	33.5	19.3	11.2	2920	89	0.89	3.3	4	1.8	10.7	83	54.2	0.020357
YDS1A 132MC2	15.0	50.4	29.1	16.8	47.9	27.7	16.0	46.2	26.7	15.4	2940	91.0	0.86	4	4.5	2.5	14	86	72	0.028557
YDS1A 160MA2	11.0	38.3	22.1	12.8	36.4	21.0	12.1	35.1	20.2	11.7	2940	90.0	0.84	2.6	3.1	1.5	7.9	86	72	0.04438
YDS1A 160MB2	15.0	51.4	29.7	17.1	48.9	28.2	16.3	47.1	27.2	15.7	2950	90.3	0.85	2.8	3.3	1.4	8.6	86	82	0.055805
YDS1A 160LA2	18.5	62.9	36.3	21.0	59.8	34.5	19.9	57.6	33.3	19.2	2950	91.0	0.85	3	3.4	1.6	9.3	86	94.1	0.065593
YDS1A 160LB2	22.0	73.7	42.6	24.6	70.0	40.4	23.4	67.5	39.0	22.5	2950	91.3	0.86	3.2	3.5	1.7	9.9	91	104.5	0.077018
YDS1A 56A4	0.06	0.56	0.33	0.19	0.54	0.31	0.18	0.52	0.30	0.17	1360	50.0	0.56	2.3	2.4	2	4	50	2.9	0.00019
YDS1A 56B4	0.09	0.77	0.45	0.26	0.73	0.42	0.24	0.71	0.41	0.24	1360	52.0	0.59	2.3	2.4	2	4	50	3.3	0.00024
YDS1A 56C4	0.12	0.95	0.55	0.32	0.90	0.52	0.30	0.87	0.50	0.29	1360	52.0	0.64	2.2	2.4	2	4	52	3.7	0.000265
YDS1A 63A4	0.12	0.95	0.55	0.32	0.90	0.52	0.30	0.87	0.50	0.29	1360	52.0	0.64	2.2	2.4	2	4	52	3.7	0.000273
YDS1A 63B4	0.18	1.28	0.74	0.43	1.21	0.70	0.40	1.17	0.68	0.39	1310	57.0	0.65	2.2	2.4	2	4	52	4.4	0.000338
YDS1A 63C4	0.25	1.66	0.96	0.55	1.58	0.91	0.53	1.52	0.88	0.51	1340	60.0	0.66	2.2	2.2	2	4	54	5	0.000408
YDS1A 71A4	0.25	1.52	0.88	0.51	1.45	0.84	0.48	1.39	0.81	0.46	1350	60.0	0.72	2.2	2.4	1.7	6	55	5.06	0.000561
YDS1A 71B4	0.37	2.02	1.17	0.67	1.92	1.11	0.64	1.85	1.07	0.62	1370	65.0	0.74	2.2	2.4	1.7	6	55	5.96	0.000714
YDS1A 71C4	0.55	2.92	1.69	0.97	2.78	1.60	0.93	2.68	1.55	0.89	1380	66.0	0.75	2.2	2.4	1.7	6	57	7.06	0.000919
YDS1A 80A4	0.55	2.64	1.53	0.88	2.51	1.45	0.84	2.42	1.40	0.81	1420	73.0	0.75	2	2.3	1.6	4.8	57	8.3	0.001453
YDS1A 80B4	0.75	3.39	1.96	1.13	3.22	1.86	1.08	3.11	1.79	1.04	1410	76.5	0.76	2	2.4	1.7	5	58	9.8	0.00169
YDS1A 80C4	1.1	4.91	2.84	1.64	4.67	2.70	1.56	4.50	2.60	1.50	1390	77.5	0.76	2.3	2.4	2	5	61	11.2	0.002166
YDS1A 90S4	1.1	4.88	2.82	1.63	4.64	2.68	1.55	4.47	2.58	1.49	1400	78.0	0.76	2.1	2.3	1.9	5	61	12.3	0.002675
YDS1A 90LA4	1.5	6.25	3.61	2.08	5.94	3.43	1.98	5.72	3.30	1.91	1410	81.0	0.78	2.6	2.4	2.1	5.7	61	15.1	0.003519
YDS1A 90LB4	2.2	8.72	5.03	2.91	8.28	4.78	2.76	7.98	4.61	2.66	1420	83.0	0.8	2.7	2.3	2.1	6.2	64	17.78	0.004685
YDS1A 100LA4	2.2	9.42	5.44	3.14	8.95	5.16	2.98	8.62	4.98	2.87	1430	80.9	0.76	2.2	2.8	1.9	6	64	20	0.006775
YDS1A 100LB4	3	11.40	6.58	3.80	10.80	6.25	3.61	10.40	6.02	3.48	1430	84.5	0.82	2.5	2.8	2.1	6.7	64	24	0.008424
YDS1A 100LC4	4	16.10	9.28	5.36	15.30	8.81	5.09	14.70	8.49	4.90	1430	84.0	0.78	2.7	3	2.3	6.9	65	28.2	0.010733
YDS1A 112MA4	4	15.80	9.11	5.26	15.00	8.66	5.00	14.50	8.34	4.82	1440	85.5	0.78	2.3	3.3	2.1	7.8	65	29.8	0.013228
YDS1A 112MB4	5.5	21.70	12.50	7.24	20.60	11.90	6.88	19.90	11.50	6.63	1450	86.5	0.77	3.4	3.5	2.6	8.6	71	36	0.016839
YDS1A 132SA4	5.5	20.50	11.90	6.84	19.50	11.30	6.50	18.80	10.90	6.26	1450	86.0	0.82	1.8	2.9	1.7	7.1	71	42	0.028012
YDS1A 132MA4	7.5	28.20	16.30	9.40	26.80	15.50	8.93	25.80	14.90	8.61	1450	87.5	0.8	2.9	3.3	1.9	8.4	71	52.6	0.037145
YDS1A 132MB4	9.2	33.80	19.50	11.30	32.10	18.50	10.70	30.90	17.90	10.30	1450	88.5	0.81	3.1	3.4	1.7	8.9	74	55	0.043597
YDS1A 132MC4	11	40.00	23.10	13.30	38.00	21.90	12.70	36.60	21.10	12.20	1450	89.4	0.81	3.5	3.5	1.7	9.4	75	64	0.051339
YDS1A 160M4	11	40.70	23.50	13.60	38.60	22.30	12.90	37.20	21.50	12.40	1460	89.0	0.8	2.3	2.8	1.3	6.8	75	74	0.080254
YDS1A 160LA4	15	53.20	30.70	17.70	50.50	29.20	16.80	48.70	28.10	16.20	1460	90.5	0.82	2.4	2.6	1.4	7.5	75	90.3	0.10564
YDS1A 160LB4	18.5	64.50	37.30	21.50	61.30	35.40	20.40	59.10	34.10	19.70	1460	90.9	0.83	2.4	2.5	1.4	7.6	78	104	0.127619
YDS1A 160LC4	22	77.20	44.60	25.80	73.40	42.40	24.50	70.70	40.80	23.60	1460	91.4	0.82	2.8	2.7	1.5	8.8	80	118.5	0.149598



IE1 YDSA series Standard Efficiency Asynchronous Motor

YDS1A Series IE1 Efficiency Motors Technical Data (at 50Hz)

Model	Output kW	Current (A)			Current (A)			Current (A)			Speed (r/min)	Eff (%)	Power Factor	Ts/Tn (Times)	Tmax/Tn (Times)	Tmin/Tn (Times)	Ist/In (Times)	Noise dB(A)	N.W (kgs)	Moment of Inertia (kg*m ²)
		220V	380V	660V	230V	400V	690V	240V	415V	720V										
YDS1A 63A6	0.09	0.92	0.53	0.31	0.88	0.51	0.29	0.85	0.49	0.28	840	42.0	0.61	2	2	1.5	3.5	50	4.2	0.000418
YDS1A 63B6	0.12	1.13	0.65	0.38	1.08	0.62	0.36	1.04	0.60	0.35	850	45.0	0.62	2	2	1.5	3.5	50	4.5	0.000517
YDS1A 71A6	0.18	1.28	0.74	0.43	1.22	0.70	0.41	1.17	0.68	0.39	880	56.0	0.66	1.6	1.7	1.5	4	52	5.6	0.000841
YDS1A 71B6	0.25	1.59	0.92	0.53	1.51	0.87	0.50	1.46	0.84	0.49	900	59.0	0.7	2.1	2.2	1.5	4	52	6	0.000965
YDS1A 71C6	0.37	2.31	1.34	0.77	2.20	1.27	0.73	2.12	1.22	0.71	890	61.0	0.69	2	2.1	1.5	4	54	6.8	0.00115
YDS1A 80A6	0.37	2.42	1.40	0.81	2.30	1.33	0.77	2.21	1.28	0.74	910	61.0	0.66	1.9	2.2	1.8	3.2	56	8	0.001596
YDS1A 80B6	0.55	3.40	1.96	1.13	3.23	1.86	1.08	3.11	1.80	1.04	910	65.5	0.65	2.1	2.3	1.9	3.5	56	9.1	0.002041
YDS1A 80C6	0.75	4.06	2.34	1.35	3.85	2.23	1.28	3.72	2.14	1.24	910	70.5	0.69	2.1	2.2	1.9	3.8	58	10.6	0.002634
YDS1A 90S6	0.75	4.06	2.34	1.35	3.86	2.23	1.29	3.72	2.15	1.24	940	71.5	0.68	1.8	2.2	1.5	4.1	59	11.5	0.003266
YDS1A 90L6	1.1	5.97	3.45	1.99	5.67	3.27	1.89	5.46	3.15	1.82	930	73.5	0.66	1.9	2.3	1.8	4.1	59	14.5	0.004281
YDS1A 90LB6	1.5	7.63	4.40	2.54	7.25	4.18	2.42	6.98	4.03	2.33	930	75.0	0.69	2	2.2	1.9	4.3	61	15.5	0.005487
YDS1A 100L6	1.5	7.43	4.29	2.48	7.06	4.08	2.35	6.80	3.93	2.27	940	77.0	0.69	1.9	2.6	1.8	4.6	61	18.7	0.007543
YDS1A 100LB6	2.2	9.71	5.61	3.24	9.22	5.33	3.07	8.89	5.13	2.96	940	79.5	0.75	2	2.3	1.8	5.1	64	22.8	0.009935
YDS1A 112MA6	2.2	10.60	6.11	3.53	10.10	5.80	3.35	9.69	5.59	3.23	945	79.3	0.69	1.9	2.3	1.8	4.8	64	24.5	0.01395
YDS1A 112MB6	3	14.10	8.16	4.71	13.40	7.75	4.47	12.90	7.47	4.31	950	81.0	0.69	1.9	2.8	1.8	5	64	28.5	0.017675
YDS1A 132S6	3	13.30	7.67	4.43	12.60	7.29	4.21	12.20	7.03	4.06	960	82.5	0.72	1.9	2.5	1.4	5.7	64	36.4	0.030457
YDS1A 132MA6	4	17.10	9.85	5.69	16.20	9.36	5.40	15.60	9.02	5.21	965	84.5	0.73	2	2.6	1.5	5.9	68	42.2	0.037251
YDS1A 132MB6	5.5	23.50	13.60	7.84	22.30	12.90	7.45	21.50	12.40	7.18	950	85.5	0.72	2.1	2.7	1.6	6.2	68	51.4	0.048966
YDS1A 132MC6	7.5	30.20	17.50	10.10	28.70	16.60	9.58	27.70	16.00	9.23	965	87.0	0.75	2.7	2.9	2	7.3	68	62.6	0.062355
YDS1A 160M6	7.5	30.20	17.50	10.10	28.70	16.60	9.58	27.70	16.00	9.23	965	87.0	0.75	2.4	2.9	1.7	6.7	68	68.3	0.086226
YDS1A 160L6	11	43.20	24.90	14.40	41.10	23.70	13.70	39.60	22.80	13.20	965	87.0	0.77	2.5	2.7	1.5	6.9	73	86	0.116874
YDS1A 71A8	0.09	0.97	0.56	0.32	0.92	0.53	0.31	0.88	0.51	0.29	680	43.0	0.57	2.4	2.5	2.3	2.5	50	5.6	0.000717
YDS1A 71B8	0.12	1.14	0.66	0.38	1.08	0.62	0.36	1.04	0.60	0.35	690	49.5	0.56	2.7	2.8	2.6	3	50	6	0.000841
YDS1A 80A8	0.18	1.48	0.86	0.49	1.41	0.81	0.47	1.36	0.79	0.45	690	55.0	0.58	2.2	2.4	2	3	52	8.3	0.002021
YDS1A 80B8	0.25	1.94	1.12	0.65	1.84	1.06	0.61	1.78	1.03	0.59	690	58.5	0.58	2.3	2.4	2	3.1	52	9.3	0.002323
YDS1A 90S8	0.37	2.58	1.49	0.86	2.45	1.41	0.82	2.36	1.36	0.79	710	64.0	0.59	1.9	2.3	1.7	3.3	56	11.38	0.003266
YDS1A 90L8	0.55	3.84	2.22	1.28	3.65	2.11	1.22	3.52	2.03	1.17	705	65.0	0.58	1.9	2.3	1.7	3.4	56	14	0.004281
YDS1A 90LB8	0.75	4.69	2.71	1.56	4.45	2.57	1.49	4.29	2.48	1.43	700	69.0	0.61	1.8	2.1	1.8	3.5	59	15.5	0.004884
YDS1A 100LA8	0.75	4.43	2.56	1.48	4.21	2.43	1.40	4.06	2.34	1.35	685	68.5	0.65	1.9	1.8	2.2	3.6	59	17.6	0.006346
YDS1A 100LB8	1.1	6.09	3.52	2.03	5.79	3.34	1.93	5.58	3.22	1.86	690	72.0	0.66	1.9	2.1	1.8	3.5	59	20	0.00834
YDS1A 112M8	1.5	7.87	4.54	2.62	7.48	4.32	2.49	7.21	4.16	2.40	700	76.0	0.66	1.8	2.3	1.8	4	61	25.3	0.01395
YDS1A 132S8	2.2	10.60	6.13	3.54	10.10	5.83	3.36	9.73	5.62	3.24	715	79.0	0.69	1.9	2.4	1.7	4.9	64	39.6	0.032131
YDS1A 132M8	3	13.90	8.04	4.64	13.20	7.64	4.41	12.70	7.36	4.25	715	81.0	0.7	2	2.5	1.8	5.1	64	47.4	0.040598
YDS1A 160MA8	4	18.30	10.60	6.11	17.40	10.10	5.81	16.80	9.70	5.60	715	82.0	0.7	1.8	2.3	1.6	4.6	68	59.8	0.071036
YDS1A 160MB8	5.5	24.80	14.30	8.25	23.50	13.60	7.84	22.70	13.10	7.56	710	83.5	0.7	1.9	2.4	1.8	4.8	68	69	0.086226
YDS1A 160L8	7.5	33.00	19.00	11.00	31.30	18.10	10.40	30.20	17.40	10.10	715	85.5	0.7	2.5	2.8	2	5.7	68	84.8	0.113076

IE2 YDSA series High Efficiency Asynchronous Motor



YDSA Series IE2 Efficiency Motors Technical Data (at 50Hz)

Model	Output kW	Current (A)			Current (A)			Current (A)			Speed (r/min)	Eff (%)	Power Factor	Tst/Tn (Times)	Tmax/Tn (Times)	Tmin/Tn (Times)	Ist/In (Times)	Noise dB(A)	N.W (kgs)	Moment of Inertia (kg·m ²)
		220V	380V	660V	230V	400V	690V	240V	415V	720V										
YDS2A 63A2	0.18	1.01	0.58	0.34	0.96	0.55	0.32	0.92	0.53	0.31	2870	65.4	0.72	2.3	2.5	1.7	4.7	59	3.6	0.000231
YDS2A 63B2	0.25	1.21	0.70	0.40	1.15	0.66	0.38	1.11	0.64	0.37	2840	69.8	0.78	2.4	2.6	2	5.2	59	3.9	0.000255
YDS2A 63C2	0.37	1.79	1.03	0.60	1.70	0.98	0.57	1.64	0.95	0.55	2840	69.8	0.78	2.2	2.4	1.8	5.2	59	4.5	0.000303
YDS2A 71A2	0.37	1.68	0.97	0.56	1.60	0.92	0.53	1.54	0.89	0.51	2840	70.5	0.82	2.2	2.2	1.4	5.1	62	5.1	0.000346
YDS2A 71B2	0.55	2.35	1.36	0.78	2.23	1.29	0.74	2.15	1.24	0.72	2860	75.1	0.82	2.3	2.4	1.5	5.9	62	6.1	0.000458
YDS2A 71C2	0.75	3.04	1.75	1.01	2.88	1.67	0.96	2.78	1.60	0.93	2840	77.4	0.84	2.5	2.6	1.7	6	63	7	0.000569
YDS2A 80A2	0.75	3.15	1.82	1.05	2.99	1.73	1.00	2.88	1.66	0.96	2840	77.4	0.81	2.6	2.8	2.2	6.1	67	8.4	0.000896
YDS2A 80B2	1.1	4.43	2.56	1.48	4.21	2.43	1.40	4.06	2.34	1.35	2860	79.6	0.82	2.6	2.6	1.8	7	67	9.8	0.001124
YDS2A 80C2	1.5	5.78	3.34	1.93	5.49	3.17	1.83	5.29	3.06	1.76	2880	81.3	0.84	2.9	3.1	2	7.4	70	11.3	0.001427
YDS2A 90S2	1.5	5.92	3.42	1.97	5.63	3.25	1.88	5.42	3.13	1.81	2880	81.3	0.82	2.8	3	2	7.2	72	12.4	0.001856
YDS2A 90LA2	2.2	8.38	4.84	2.79	7.96	4.60	2.66	7.68	4.43	2.56	2890	83.2	0.83	2.8	3.1	1.4	7.6	72	15	0.002306
YDS2A 90LB2	3	11.00	6.34	3.66	10.40	6.02	3.48	10.05	5.80	3.35	2880	84.6	0.85	3.4	3.3	2.3	7.9	74	17.2	0.002966
YDS2A 100LA2	3	10.70	6.19	3.58	10.20	5.88	3.40	9.82	5.67	3.27	2910	84.6	0.87	3.1	3.5	2.6	8.8	76	22	0.004131
YDS2A 100LB2	4	14.10	8.14	4.70	13.40	7.73	4.47	12.90	7.46	4.30	2910	85.8	0.87	3.7	4.2	3.8	9.9	77	25.8	0.005197
YDS2A 112MA2	4	13.80	7.96	4.60	13.10	7.56	4.37	12.60	7.29	4.21	2920	85.8	0.89	3.3	3.6	2	9.6	77	26.7	0.006311
YDS2A 112MB2	5.5	19.10	11.00	6.37	18.20	10.50	6.06	17.50	10.10	5.84	2920	87.0	0.87	3.4	4.1	2.8	10.2	78	32.5	0.008057
YDS2A 132SA2	5.5	18.70	10.80	6.23	17.80	10.30	5.92	17.10	9.90	5.71	2920	87.0	0.89	2.4	3.4	1.9	8.3	80	39.7	0.013319
YDS2A 132SB2	7.5	25.20	14.50	8.39	23.90	13.80	7.97	23.00	13.30	7.68	2920	88.1	0.89	3.1	3.7	2	10.3	80	47.3	0.016473
YDS2A 132MA2	9.2	30.70	17.70	10.20	29.10	16.80	9.71	28.10	16.20	9.36	2920	88.7	0.89	3.4	4.1	1.4	10.8	81	52	0.017834
YDS2A 132MB2	11	36.00	20.80	12.00	34.20	19.70	11.40	32.90	19.00	11.00	2930	89.4	0.9	4	3.9	1.7	12.7	83	58.5	0.021619
YDS2A 132MC2	15	48.60	28.00	16.20	46.10	26.60	15.40	44.50	25.70	14.80	2940	90.3	0.9	3.7	4.3	1.7	13.6	86	74	0.028557
YDS2A 160MA2	11	36.40	21.00	12.10	34.60	20.00	11.50	33.30	19.20	11.10	2950	89.4	0.89	2.6	3.4	1.5	8.4	86	79	0.050092
YDS2A 160MB2	15	48.60	28.00	16.20	46.10	26.60	15.40	44.50	25.70	14.80	2950	90.3	0.9	2.6	3.4	1.8	9.4	86	91	0.065326
YDS2A 160LA2	18.5	59.50	34.40	19.80	56.50	32.60	18.80	54.50	31.50	18.20	2950	90.9	0.9	2.6	3.2	1.8	9.4	86	101	0.077018
YDS2A 160LB2	22	69.70	40.20	23.20	66.20	38.20	22.10	63.80	36.80	21.30	2950	91.3	0.91	3.1	3.6	1.8	10.6	91	112.5	0.090348
YDS2A 63A4	0.12	0.81	0.47	0.27	0.77	0.44	0.26	0.74	0.43	0.25	1395	60.1	0.65	2.2	2.3	1.7	3.5	49	3.7	0.000274
YDS2A 63B4	0.18	1.03	0.60	0.34	0.98	0.57	0.33	0.94	0.55	0.31	1375	64.7	0.71	2.2	2.3	1.8	3.8	49	4.4	0.000336
YDS2A 63C4	0.25	1.30	0.75	0.43	1.23	0.71	0.41	1.19	0.69	0.40	1360	68.5	0.74	2.1	2.3	2	4	49	5	0.000399
YDS2A 71A4	0.25	1.41	0.81	0.47	1.34	0.77	0.45	1.29	0.75	0.43	1400	69.6	0.67	2.2	2.3	1.8	4.1	52	5.3	0.000593
YDS2A 71B4	0.37	1.83	1.06	0.61	1.74	1.01	0.58	1.68	0.97	0.56	1400	72.7	0.73	2.3	2.4	1.9	4.7	53	6.5	0.000816
YDS2A 80A4	0.55	2.68	1.55	0.89	2.55	1.47	0.85	2.46	1.42	0.82	1420	77.1	0.7	2.4	2.8	2.1	5.4	55	8.3	0.001453
YDS2A 80B4	0.75	3.49	2.02	1.16	3.32	1.92	1.11	3.20	1.85	1.07	1420	79.6	0.71	2.7	2.9	2.4	5.7	58	10.4	0.001928
YDS2A 80C4	1.1	4.94	2.85	1.65	4.69	2.71	1.56	4.52	2.61	1.51	1420	81.4	0.72	3.1	3.1	2.5	5.9	61	12.3	0.002522
YDS2A 90S4	1.1	4.81	2.77	1.60	4.57	2.64	1.52	4.40	2.54	1.47	1440	81.4	0.74	2.9	3.1	2.2	6.8	61	13.8	0.003342
YDS2A 90LA4	1.5	6.44	3.72	2.15	6.12	3.53	2.04	5.90	3.41	1.97	1440	82.8	0.74	3.1	3.2	2.2	6.5	61	16.1	0.004185
YDS2A 90LB4	2.2	9.16	5.29	3.05	8.70	5.02	2.90	8.38	4.84	2.80	1430	84.3	0.75	3.4	2.4	2.2	7.1	64	18.8	0.005352
YDS2A 100LA4	2.2	8.38	4.84	2.79	7.96	4.59	2.65	7.67	4.43	2.56	1440	84.3	0.82	2.4	2.9	2	6.6	64	22	0.007765
YDS2A 100LB4	3	11.50	6.66	3.85	11.00	6.33	3.66	10.60	6.10	3.52	1450	85.5	0.8	2.3	3.2	2.4	7.6	64	25.8	0.009743
YDS2A 100LC4	4	15.20	8.77	5.06	14.40	8.33	4.81	13.90	8.03	4.64	1440	86.6	0.8	2.8	3.2	2.3	7.2	65	28.6	0.011063
YDS2A 112MA4	4	14.80	8.56	4.94	14.10	8.13	4.69	13.60	7.84	4.52	1440	86.6	0.82	2.5	3.3	2.3	7.9	65	31.4	0.013744
YDS2A 112MB4	5.5	20.60	11.90	6.88	19.60	11.30	6.53	18.90	10.90	6.30	1440	87.7	0.8	3.7	3.6	3.1	8.3	71	36.7	0.017355
YDS2A 132S4	5.5	19.90	11.50	6.63	18.90	10.90	6.30	18.20	10.50	6.07	1460	87.7	0.83	2.1	3.5	1.9	8.6	71	44.3	0.030593
YDS2A 132MA4	7.5	26.80	15.50	8.94	25.50	14.70	8.49	24.50	14.20	8.18	1460	88.7	0.83	2.7	3.2	1.7	8.9	71	54.5	0.039726
YDS2A 132MB4	9.2	31.90	18.40	10.60	30.30	17.50	10.10	29.20	16.90	9.70	1460	89.2	0.85	2.9	3.2	1.7	8.7	74	56.6	0.046178
YDS2A 132MC4	11	37.90	21.90	12.60	36.00	20.80	12.00	34.70	20.00	11.60	1460	89.8	0.85	3.3	3.6	1.4	9.3	75	68	0.05392
YDS2A 160M4	11	38.80	22.40	12.90	36.90	21.30	12.30	35.60	20.50	11.90	1460	89.8	0.83	2.5	2.7	1.7	7	75	82	0.089674
YDS2A 160LA4	15	51.90	29.90	17.30	49.30	28.40	16.40	47.50	27.40	15.80	1470	90.6	0.84	2.5	2.8	1.6	8.3	75	103	0.118199
YDS2A 160LB4	18.5	63.50	36.70	21.20	60.40	34.90	20.10	58.20	33.60	19.40	1470	91.2	0.84	2.7	3	1.7	8.8	78	115	0.137038
YDS2A 63B6	0.12	0.93	0.54	0.31	0.88	0.51	0.29	0.85	0.49	0.28	850	50.6	0.67	1.8	2	1.8	2.8	46	4.8	0.000521
YDS2A 71A6	0.18	1.25	0.72	0.42	1.19	0.69	0.40	1.14	0.66	0.38	850	56.6	0.67	1.9	2.2	1.7	3.1	50	5.3	0.000713
YDS2A 71B6	0.25	1.62	0.93	0.54	1.54	0.89	0.51	1.48	0.86	0.49	910	61.6	0.66	2.1	2.3	1.9	3.4	50	6.1	0.000943
YDS2A 80A6	0.37	2.12	1.22	0.71	2.01	1.16	0.67	1.94	1.12	0.65	925	67.6	0.68	1.9	2.2	1.7	3.9	54	8.3	0.001745
YDS2A 80B6	0.55	2.87	1.66	0.96	2.73	1.57	0.91	2.63	1.52	0.88	925	73.1	0.69	2.2	2.5	2.1	4.4	54	9.8	0.002338
YDS2A 80C6	0.75	3.88	2.24	1.29	3.69	2.13	1.23	3.55	2.05	1.18	920	75.9	0.67	2.7	2.6	2.5	4.2	58	11.7	0.003079
YDS2A 90S6	0.75	4.00	2.31	1.33	3.80	2.19	1.27	3.66	2.11	1.22	940	75.9	0.65	2.2	2.5	1.9	4.5	59	12.6	0.003467
YDS2A 90L6	1.1	5.37	3.10	1.79	5.10	2.95	1.70	4.92	2.84	1.64	950	78.1	0.69	2	2.4	1.8	4.9	59	15.2	0.004884
YDS2A 90LB6	1.5	7.27	4.20	2.42	6.91	3.99	2.30	6.66	3.85	2.22	945	79.8	0.68	2.7	3	2.5	5.1	61	18.2	0.006292
YDS2A 100L6	1.5	6.68	3.86	2.23	6.35	3.67	2.12	6.12	3.53	2.04	950	79.8	0.74	1.7	2.2	1.6	4.8	61	20.7	0.00834
YDS2A 100LB6	2.2	9.83	5.68	3.28	9.34	5.39	3.11	9.00	5.20	3.00	950	81.8	0.72	2.5	2.7	2.1	5.5	64	25	0.011529
YDS2A 112M6	2.2	9.70	5.60	3.23	9.21	5.32	3.07	8.88	5.13	2.96	955	81.8	0.73	2.1	2.7	1.8	5.5	64	26	0.01544
YDS2A 112MB6	3	13.																		



IE3 YDSA series Premium Efficiency Asynchronous Motor

YDSA Series IE3 Efficiency Motors Technical Data (at 50Hz)

Model	Output kW	Current (A)			Current (A)			Current (A)			Speed (r/min)	Eff			Power Factor	Tst/Tn (Times)	Tmax/Tn (Times)	Tmin/Tn (Times)	Ist/In (Times)	Noise dB(A)	N.W (kgs)	Moment of Inertia (kg·m ²)
		220V	380V	660V	230V	400V	690V	240V	415V	720V		100%	75%	50%								
YDSA63A2	0.18	0.96	0.55	0.32	0.91	0.53	0.30	0.88	0.51	0.29	2850	65.9	63.5	56.2	0.75	2	2.5	1.6	4.7	61	3.6	0.00231
YDSA63B2	0.25	1.21	0.70	0.40	1.15	0.66	0.38	1.11	0.64	0.37	2840	69.7	68.4	62.5	0.78	2.5	2.7	2	5.2	61	3.9	0.00255
YDSA71A2	0.37	1.74	1.00	0.58	1.65	0.95	0.55	1.59	0.92	0.53	2860	73.8	72.4	66.5	0.76	2.5	2.8	1.8	5.6	64	5.2	0.00369
YDSA71B2	0.55	2.33	1.34	0.78	2.21	1.28	0.74	2.13	1.23	0.71	2860	77.8	63.5	56.2	0.8	3.1	3.1	2	6.5	64	6.2	0.00495
YDSA71C2	0.75	2.98	1.72	0.99	2.83	1.64	0.94	2.73	1.58	0.91	2870	80.7	80.8	78.2	0.82	3	3.2	2.2	7.1	65	7.1	0.00606
YDSA80A2	0.75	3.02	1.74	1.01	2.87	1.66	0.96	2.76	1.60	0.92	2890	80.7	80.3	77.2	0.81	3.1	3.2	2.3	7.4	67	8.9	0.00972
YDSA80B2	1.1	4.22	2.43	1.41	4.01	2.31	1.34	3.86	2.23	1.29	2890	82.7	82.5	79.9	0.83	3.4	3.4	2	8.7	67	10.6	0.01275
YDSA80C2	1.5	5.79	3.34	1.93	5.50	3.17	1.83	5.30	3.06	1.77	2910	84.2	83.9	81.5	0.81	4	4	2.2	9.6	70	12.5	0.01654
YDSA90S2	1.5	5.72	3.30	1.91	5.43	3.14	1.81	5.24	3.02	1.75	2900	84.2	83.8	81.4	0.82	3.5	3.7	2.1	8.3	72	14	0.02186
YDSA90LA2	2.2	8.22	4.75	2.74	7.81	4.51	2.60	7.53	4.35	2.51	2910	85.9	86.1	84.7	0.82	3.1	3.5	2.2	8.1	72	16.3	0.02636
YDSA90LB2	3	11.30	6.54	3.78	10.80	6.21	3.59	10.37	5.99	3.46	2910	87.1	87.1	84.2	0.8	4	4.1	2.6	9.6	74	18.5	0.03406
YDSA100LA2	3	10.20	5.88	3.39	9.70	5.59	3.23	9.33	5.38	3.11	2910	87.1	87.5	86.3	0.89	3.2	3.6	2.6	9.4	76	23.7	0.04842
YDSA100LB2	4	13.30	7.66	4.43	12.60	7.28	4.20	12.20	7.02	4.05	2910	88.1	88.7	88.1	0.9	3.3	3.6	2.3	10.1	77	27.6	0.05907
YDSA112MA2	4	13.10	7.58	4.38	12.50	7.20	4.16	12.00	6.94	4.01	2920	88.1	88.2	87	0.91	3.4	3.9	2.4	10.5	77	30.1	0.07505
YDSA112MB2	5.5	17.80	10.30	5.94	16.90	9.78	5.65	16.30	9.43	5.44	2920	89.2	89.6	89.1	0.91	3.3	4.2	2.9	11.9	78	35.7	0.09251
YDSA132SA2	5.5	18.20	10.50	6.08	17.30	10.00	5.77	16.70	9.64	5.56	2930	89.2	89.4	88.2	0.89	3.2	4	2.5	10	80	43.4	0.15212
YDSA132SB2	7.5	24.30	14.10	8.11	23.10	13.40	7.71	22.30	12.90	7.43	2930	90.1	90.2	89.1	0.9	3.6	4.7	2.4	11.9	80	51.7	0.18996
YDSA132MA2	9.2	29.40	17.00	9.79	27.90	16.10	9.30	26.90	15.50	8.96	2930	90.6	91.2	90.5	0.91	3.2	4.2	2.6	11.6	81	58.3	0.21619
YDSA132MB2	11	34.50	19.90	11.50	32.80	18.90	10.90	31.60	18.20	10.50	2930	91.2	91.5	91.2	0.92	3.6	4.1	2.4	12.2	83	63.5	0.24142
YDSA132MC2	15	47.70	27.60	15.90	45.30	26.20	15.10	43.70	25.20	14.60	2940	91.9	92.1	91.2	0.9	4.9	4.9	2	14.4	86	75	0.28557
YDSA160MA2	11	36.10	20.80	12.00	34.30	19.80	11.40	33.00	19.10	11.00	2960	91.2	91	89.6	0.88	3.2	4	1.4	10.3	86	85.5	0.059613
YDSA160MB2	15	48.30	27.90	16.10	45.80	26.50	15.30	44.20	25.50	14.70	2960	91.9	91.5	89.9	0.89	3.9	4.2	1.4	11.4	86	104	0.076751
YDSA160LA2	18.5	57.90	33.40	19.30	55.00	31.80	18.30	53.00	30.60	17.70	2950	92.4	92.8	91.8	0.91	3	3	1.5	9.1	86	121	0.092252
YDSA180M2	22	68.60	39.60	22.90	65.20	37.60	21.70	62.80	36.30	20.90	2960	92.7	93	92.4	0.91	2.7	3.3	1.7	9	91	130.6	0.104677
YDSA63A4	0.12	0.70	0.40	0.23	0.66	0.38	0.22	0.64	0.37	0.21	1360	64.8	63.7	57.6	0.7	2.2	2.3	2	3.5	52	3.8	0.000305
YDSA63B4	0.18	0.97	0.56	0.32	0.92	0.53	0.31	0.89	0.51	0.30	1400	69.9	69.6	65.4	0.7	2.2	2.5	2.1	4.1	52	4.5	0.000399
YDSA71A4	0.25	1.30	0.75	0.43	1.23	0.71	0.41	1.19	0.69	0.40	1410	73.5	73.2	69	0.69	2.3	2.5	2.1	4.5	55	5.8	0.000717
YDSA71B4	0.37	1.85	1.07	0.62	1.76	1.02	0.59	1.70	0.98	0.57	1420	77.3	77.1	73.6	0.68	2.8	3	2.5	5.2	55	7	0.000965
YDSA80A4	0.55	2.80	1.62	0.93	2.66	1.54	0.89	2.56	1.48	0.85	1440	80.8	79.9	76	0.64	3.1	3.3	2.4	6.2	57	9.5	0.00169
YDSA80B4	0.75	3.47	2.00	1.16	3.29	1.90	1.10	3.17	1.83	1.06	1440	82.5	82.5	80.1	0.69	3.1	3.1	2.5	6.3	58	11.7	0.002285
YDSA80C4	1.1	4.65	2.69	1.55	4.42	2.55	1.47	4.26	2.46	1.42	1430	84.1	84.9	83.7	0.74	3	3.1	2.6	6.6	61	13.8	0.002998
YDSA90S4	1.1	4.72	2.72	1.57	4.48	2.59	1.49	4.32	2.49	1.44	1440	84.1	84.2	82.9	0.73	4	3.4	2.5	7.1	61	15.1	0.003842
YDSA90LA4	1.5	6.25	3.61	2.08	5.94	3.43	1.98	5.73	3.31	1.91	1430	85.3	85.5	84.1	0.74	3.4	3.3	2.8	7.1	61	18	0.004685
YDSA100LA4	2.2	8.35	4.82	2.78	7.93	4.58	2.64	7.64	4.41	2.55	1450	86.7	87.1	86.2	0.8	2.8	3.3	2.3	7.9	64	23.9	0.008754
YDSA100LB4	3	11.50	6.66	3.85	11.00	6.33	3.65	10.60	6.10	3.52	1450	87.7	88	86.9	0.78	3.3	3.4	2.7	8.1	64	28.3	0.011063
YDSA112MA4	4	14.50	8.37	4.83	13.80	7.95	4.59	13.30	7.66	4.42	1450	88.6	88.8	88.2	0.82	3.1	3.7	2.6	8.6	65	33.9	0.015292
YDSA112MB4	5.5	20.20	11.70	6.73	19.20	11.10	6.39	18.50	10.70	6.16	1450	89.6	89.9	89.1	0.8	3.8	3.7	2.5	9.1	71	39.1	0.048758
YDSA132S4	5.5	19.20	11.10	6.41	18.30	10.50	6.09	17.60	10.20	5.87	1460	89.6	89.8	89.4	0.84	2.3	3.5	1.9	9	71	47.4	0.034464
YDSA132MA4	7.5	26.00	15.00	8.66	24.70	14.30	8.23	23.80	13.70	7.93	1460	90.4	90.9	90.3	0.84	2.6	3.4	2.2	8.9	71	57.4	0.043597
YDSA132MB4	9.2	32.50	18.80	10.80	30.90	17.80	10.30	29.80	17.20	9.93	1460	90.8	91.3	90.7	0.82	3.2	3.6	2	10	74	60	0.051339
YDSA132MC4	11	37.70	21.80	12.60	35.80	20.70	11.90	34.50	19.90	11.50	1460	91.4	92	91.6	0.84	3.5	3.7	2.1	10.5	75	67	0.060372
YDSA160MA4	11	38.20	22.00	12.70	36.30	20.90	12.10	34.90	20.20	11.60	1470	91.4	91.7	89.8	0.83	2.6	2.8	1.8	7.6	75	89	0.105373
YDSA160LA4	15	50.40	29.10	16.80	47.90	27.70	16.00	46.20	26.70	15.40	1470	92.1	92.3	91.3	0.85	3	3	2	9.2	75	110.5	0.137038
YDSA180M4	18.5	61.10	35.30	20.40	58.10	33.50	19.40	56.00	32.30	18.70	1470	92.6	92.8	92.1	0.86	2.8	3.3	1.9	8.8	80	130	0.173293
YDSA180L4	22	72.40	41.80	24.10	68.80	39.70	22.90	66.30	38.30	22.10	1470	93.0	93.1	92.3	0.86	3	3.5	2.1	9.3	80	145.4	0.200637
YDSA71A6	0.18	1.20	0.69	0.40	1.14	0.66	0.38	1.09	0.63	0.36	930	63.9	61	53.4	0.62	2.4	2.6	2.3	3.5	52	5.4	0.00079
YDSA71B6	0.25	1.48	0.85	0.49	1.40	0.81	0.47	1.35	0.78	0.45	920	68.6	67.2	61.2	0.65	2.2	2.5	2.2	3.7	52	6.3	0.00102
YDSA80A6	0.37	1.95	1.12	0.65	1.85	1.07	0.62	1.78	1.03	0.59	930	73.5	73.8	70.5	0.68	2.2	2.5	2.1	4.1	56	9.3	0.002189
YDSA80B6	0.55	2.64	1.52	0.88	2.51	1.45	0.84	2.42	1.40	0.81	930	77.2	78.1	75.7	0.71	2.3	2.4	2.1	4.3	56	10.9	0.002931
YDSA90S6	0.75	3.73	2.16	1.24	3.55	2.05	1.18	3.42	1.97	1.14	950	78.9	80.1	78.1	0.67	2.3	2.6	2.1	4.7	59	13.8	0.00407
YDSA90L6	1.1	5.33	3.08	1.78	5.07	2.93	1.69	4.88	2.82	1.63	950	81.0	81.1	78.4	0.67	2.7	2.9	2.5	5.2	59	16.2	0.005487
YDSA90LB6	1.5	7.14	4.12	2.38	6.78	3.92	2.26	6.54	3.78	2.18	950	82.5	82.7	80.5	0.67	2.9	3	2.6	5.6	61	21.3	0.006895
YDSA100L6	1.5	6.84	3.95	2.28	6.49	3.75	2.16	6.26	3.61	2.09	955	82.5	83	81.8	0.7	2.4	2.9	2.2	5.5	61	22.1	0.009137
YDSA100LB6	2.2	9.54	5.51	3.18	9.06	5.23	3.02	8.73	5.04	2.91	955	84.3	85.1	83.9	0.72	2.5	3	2.3	6.2	64	27.7	0.012725
YDSA112M6	2.2	10.10	5.83	3.37	9.59	5.54	3.20	9.25	5.34	3.08	965	84.3	84.5	83.2	0.68	2	2.5	1.8	5.5	64	27.1	0.017675
YDSA112MB6	3	13.40	7.72	4.46	12.70	7.33	4.23	12.20	7.07	4.08	965	85.6	86.2	84.8	0.69	2.5	2.9	1.9	6.3	64		



YDS1C Series IE1 Efficiency Motors Technical Data (at 50Hz)

Model	Output kW	Rated Current (A)	Speed (r/min)	Efficiency			Power Factor	Rated Torque (N/m)	Ts/Tn (Times)	Tmax/Tn (Times)	Tmin/Tn (Times)	Ist/In (Times)	Noise dB(A)	N.W (kgs)	Moment of Inertia (kg*m2)
				100%	75%	50%									
YDS1C 80A2	0.75	2.1	2840	72.1	73.3	69.0	0.73	2.52	2.2	1.8	2.3	6.0	67	14.3	0.00093
YDS1C 80B2	1.1	2.9	2840	75.0	77.7	74.8	0.73	3.70	2.2	1.8	2.3	7.0	67	16	0.0011
YDS1C 90S2	1.5	3.8	2840	77.2	78.5	75.1	0.74	5.04	2.2	1.8	2.3	7.0	72	18.5	0.00184
YDS1C 90L2	2.2	5.0	2840	79.7	80.9	78.8	0.79	7.40	2.2	1.8	2.3	7.5	72	22	0.00239
YDS1C 100L2	3	6.6	2840	81.5	82.8	80.1	0.81	10.09	2.2	1.8	2.3	7.5	76	32	0.00368
YDS1C 112M2	4	8.6	2900	83.1	84.9	82.6	0.81	13.17	2.2	1.8	2.3	7.5	77	41	0.01613
YDS1C 132SA2	5.5	11.2	2900	84.7	85.5	82.8	0.84	18.11	2.2	1.8	2.3	7.5	80	57.5	0.01106
YDS1C 132SB2	7.5	14.8	2900	86.0	87.1	84.7	0.85	24.70	2.2	1.8	2.3	7.5	80	62	0.01468
YDS1C 132MA2	9.2	17.8	2900	87.0	88.2	86.1	0.86	30.30	2.2	1.4	2.3	7.5	80	68.5	0.01767
YDS1C 160MA2	11	20.1	2945	87.6	88.9	86.6	0.90	35.67	2.2	1.4	2.3	8.5	86	111	0.0415
YDS1C 160MB2	15	27.7	2945	88.7	90.0	88.1	0.88	48.64	2.2	1.4	2.3	9.0	86	122	0.05384
YDS1C 160L2	18.5	35.2	2945	89.3	91.0	89.5	0.85	59.99	2.2	1.4	2.3	10.0	86	140	0.06436
YDS1C 180M2	22	39.3	2945	89.9	89.9	87.6	0.90	71.34	2.2	1.3	2.3	8.0	89	153	0.0811
YDS1C 200LA2	30	53.0	2950	90.7	91.4	89.7	0.90	97.12	2.0	1.3	2.3	7.5	92	118	0.15138
YDS1C 200LB2	37	65.1	2950	91.2	92.7	91.5	0.90	119.80	2.0	1.3	2.3	7.5	92	230	0.17351
YDS1C 225M2	45	78.7	2955	91.7	91.4	89.7	0.90	145.40	2.0	1.3	2.3	7.5	92	303	0.24178
YDS1C 250M2	55	95.8	2970	92.1	92.5	90.7	0.90	176.90	2.0	1.3	2.3	9.0	93	391	0.38903
YDS1C 280S2	75	129.7	2970	92.7	92.9	91.1	0.90	241.20	2.0	1.3	2.3	9.0	94	530	0.69871
YDS1C 280M2	90	155.2	2970	93.0	92.8	90.9	0.90	289.40	2.0	1.3	2.3	9.0	94	572	0.79539
YDS1C 315S2	110	189.1	2970	93.3	94.0	92.5	0.90	353.70	2.0	1.5	2.2	7.0	96	900	1.41216
YDS1C 315M2	132	223.9	2970	93.5	94.1	92.8	0.91	424.40	2.0	1.5	2.2	7.0	96	970	1.55013
YDS1C 315LA2	160	273.6	2970	93.8	94.2	93.0	0.90	514.50	2.0	1.5	2.2	7.0	99	1010	1.71199
YDS1C 315LB2	200	341.2	2970	94.0	94.3	93.1	0.90	643.10	2.0	1.5	2.2	7.0	99	1070	1.90623
YDS1C 355MA2	220	375.3	2980	94.0	94.3	93.1	0.90	705.00	2.0	1.2	2.2	7.0	103	1590	2.95585
YDS1C 355MB2	250	426.5	2980	94.0	94.4	93.2	0.90	801.20	2.0	1.2	2.2	7.0	103	1650	3.14272
YDS1C 355LA2	280	477.7	2980	94.0	94.5	93.2	0.90	897.30	2.0	1.2	2.2	7.0	103	1715	3.47911
YDS1C 355LB2	315	537.4	2980	94.0	94.5	93.2	0.90	1009.50	2.0	1.2	2.2	7.0	103	1780	3.85287
YDS1C 80A4	0.55	1.5	1420	70.0	72.5	70.2	0.75	3.70	2.3	2.0	2.6	6.0	58	13.5	0.00141
YDS1C 80B4	0.75	2.0	1420	72.1	79.2	76.8	0.75	5.04	2.3	2.0	2.6	6.0	58	14.6	0.00168
YDS1C 90S4	1.1	2.8	1430	75.0	77.8	74.5	0.75	7.35	2.3	2.0	2.6	6.5	61	18	0.00238
YDS1C 90L4	1.5	3.7	1430	77.2	80.0	77.3	0.76	10.02	2.3	2.0	2.6	6.5	61	23	0.00335
YDS1C 100LA4	2.2	5.0	1430	79.7	79.3	75.6	0.80	14.69	2.2	2.0	2.6	6.5	64	32	0.00688
YDS1C 100LB4	3	6.6	1435	81.5	82.6	79.9	0.80	19.97	2.2	2.0	2.6	7.5	64	35	0.00883
YDS1C 112M4	4	8.5	1435	83.1	86.2	84.7	0.82	26.62	2.2	2.0	2.6	7.5	65	44	0.01311
YDS1C 132S4	5.5	11.3	1440	84.7	87.5	85.6	0.83	36.48	2.2	1.6	2.6	7.5	71	61	0.02679
YDS1C 132M4	7.5	14.8	1440	86.0	88.6	86.9	0.85	49.74	2.2	1.6	2.6	7.5	71	76	0.03694
YDS1C 132MB4	9.2	18.2	1440	86.0	88.6	85.8	0.85	61.01	2.2	1.6	2.6	7.5	71	79	0.04412
YDS1C 160M4	11	21.6	1465	87.6	89.7	88.8	0.84	71.71	2.2	1.6	2.6	8.5	75	115	0.07659
YDS1C 160L4	15	28.1	1465	88.7	90.8	90.2	0.87	97.78	2.2	1.6	2.6	8.0	75	137	0.10379
YDS1C 180M4	18.5	34.0	1465	89.3	90.6	89.3	0.88	120.60	2.2	1.6	2.6	8.0	76	149.5	0.14084
YDS1C 180L4	22	40.1	1465	89.9	90.7	89.3	0.88	143.40	2.2	1.6	2.6	8.0	76	165	0.16541
YDS1C 200L4	30	56.2	1475	90.7	92.3	91.6	0.85	194.20	2.2	1.6	2.6	8.0	79	216.5	0.26594
YDS1C 225S4	37	68.9	1480	91.2	90.9	88.8	0.85	238.80	2.2	1.3	2.6	7.0	81	293	0.50439
YDS1C 225M4	45	83.3	1480	91.7	92.6	91.0	0.85	290.40	2.2	1.3	2.6	7.0	81	335	0.57909
YDS1C 250M4	55	100.2	1480	92.1	92.4	90.7	0.86	354.90	2.2	1.3	2.6	8.0	83	397	0.69098
YDS1C 280S4	75	131.2	1480	92.7	93.1	93.2	0.89	484.00	2.2	1.3	2.6	9.0	86	540	1.41285
YDS1C 280M4	90	155.2	1480	93.0	93.4	93.5	0.90	580.70	2.2	1.3	2.6	9.0	86	620	1.74607
YDS1C 315S4	110	189.1	1480	93.3	93.8	93.2	0.90	709.80	2.0	1.3	2.3	7.0	93	915	2.90486
YDS1C 315M4	132	226.4	1480	93.5	94.0	93.6	0.90	851.80	2.0	1.3	2.3	7.0	93	1005	3.29579
YDS1C 315LA4	160	273.6	1480	93.8	94.0	93.5	0.90	1032.40	2.0	1.3	2.3	7.0	97	1068	3.73367
YDS1C 315LB4	200	341.2	1480	94.0	94.3	93.9	0.90	1290.50	2.0	1.3	2.3	7.0	97	1210	4.67201
YDS1C 355MA4	220	379.6	1480	94.0	94.5	94.0	0.89	1419.60	2.0	1.2	2.3	7.0	101	1560	6.872
YDS1C 355MB4	250	431.3	1480	94.0	94.5	94.0	0.89	1613.20	2.0	1.2	2.3	7.0	101	1600	7.6382
YDS1C 355LA4	280	483.1	1480	94.0	94.5	94.0	0.89	1806.80	2.0	1.2	2.3	7.0	101	1650	8.31927
YDS1C 355LB4	315	537.4	1485	94.0	94.6	94.1	0.90	2025.80	2.0	1.2	2.3	7.0	101	1700	9.08547
YDS1C 355LC4	355	605.7	1485	94.0	94.6	94.1	0.90	2283.00	2.0	1.2	2.3	7.0	101	1780	10.10708



YDS1C Series IE1 Efficiency Motors Technical Data (at 50Hz)

Model	Output kW	Rated Current (A)	Speed (r/min)	Efficiency			Power Factor	Rated Torque (N/m)	Tst/Tn (Times)	Tmax/Tn (Times)	Tmin/Tn (Times)	Ist/In (Times)	Noise dB(A)	N.W (kgs)	Moment of Inertia (kg*m2)
				100%	75%	50%									
YDS1C 80A6	0.37	1.5	900	59.7	60.5	55.7	0.60	3.93	2.0	1.8	2.2	5.5	54	14	0.00231
YDS1C 80B6	0.55	2.0	900	65.8	66.1	62.3	0.62	5.84	2.0	1.8	2.2	5.5	54	15	0.00284
YDS1C 90S6	0.75	2.3	935	70.0	70.4	65.8	0.66	7.66	2.0	1.8	2.2	5.5	57	19	0.00335
YDS1C 90L6	1.1	3.2	935	72.9	74.2	70.8	0.68	11.24	2.0	1.8	2.2	5.5	57	21.6	0.00461
YDS1C 100L6	1.5	3.9	940	75.2	75.7	72.4	0.73	15.24	2.0	1.8	2.2	5.5	61	29.5	0.00783
YDS1C 112M6	2.2	5.7	940	77.7	79.3	76.2	0.72	22.35	2.0	1.8	2.2	6.0	65	38	0.01383
YDS1C 132S6	3	7.2	940	79.7	80.2	76.8	0.75	30.48	2.0	1.8	2.2	6.0	69	49.6	0.02855
YDS1C 132MA6	4	9.6	950	81.4	82.8	80.1	0.74	40.21	2.0	1.8	2.5	6.0	69	59.4	0.03601
YDS1C 132MB6	5.5	12.9	950	83.1	83.0	80.6	0.74	55.29	2.0	1.8	2.5	7.5	69	65	0.0489
YDS1C 160M6	7.5	16.8	965	84.7	87.0	85.2	0.76	74.22	2.0	1.3	2.5	7.5	73	112	0.08726
YDS1C 160L6	11	24.2	970	86.4	86.7	84.4	0.76	108.30	2.0	1.3	2.5	7.5	73	122.4	0.10963
YDS1C 180L6	15	29.7	970	87.7	89.1	87.8	0.83	147.70	1.8	1.2	2.2	8.0	73	161.5	0.24936
YDS1C 200LA6	18.5	34.3	970	88.6	90.9	90.3	0.88	182.10	1.8	1.2	2.2	8.0	76	208.3	0.36147
YDS1C 200LB6	22	40.5	970	89.2	91.0	90.5	0.88	216.60	1.8	1.2	2.2	8.0	76	218.2	0.39445
YDS1C 225M6	30	55.2	975	90.2	91.2	89.9	0.87	293.80	1.8	1.2	2.2	7.0	76	289	0.55616
YDS1C 250M6	37	70.0	980	90.8	90.7	88.6	0.84	360.60	2.0	1.3	2.2	7.5	78	380	0.96477
YDS1C 280S6	45	83.6	980	91.4	92.6	91.6	0.85	438.50	2.0	1.3	2.2	7.5	80	489.5	1.68116
YDS1C 280MA6	55	100.4	980	91.9	93.3	92.5	0.86	536.00	2.0	1.3	2.2	7.5	80	560	1.99928
YDS1C 315S6	75	135.9	985	92.6	93.4	92.2	0.86	727.20	2.0	1.3	2.3	7.0	85	806	3.25976
YDS1C 315M6	90	162.6	985	92.9	93.5	92.5	0.86	872.60	2.0	1.3	2.3	7.0	85	912	3.90933
YDS1C 315LA6	110	197.9	985	93.3	93.5	92.3	0.86	1066.50	2.0	1.3	2.3	7.0	85	965	4.54331
YDS1C 315LB6	132	236.9	985	93.5	93.6	92.5	0.86	1279.80	2.0	1.3	2.3	7.0	85	1070	5.44899
YDS1C 355MA6	160	276.6	990	93.8	93.5	92.7	0.89	1543.40	2.0	1.2	2.2	8.0	92	1537	8.97637
YDS1C 355MB6	200	341.2	990	94.0	93.5	92.8	0.90	1929.30	2.0	1.2	2.2	8.0	92	1720	11.00175
YDS1C 355L6	250	426.5	990	94.0	93.6	92.8	0.90	2411.60	2.0	1.2	2.2	8.0	92	1880	13.56011
YDS1C 80A8	0.18	0.8	680	51.0	52.5	48.5	0.61	3.50	1.5	1.3	1.7	2.8	52	15	0.00214
YDS1C 80B8	0.25	1.1	680	56.0	58.2	52.5	0.61	3.50	1.6	1.3	2.0	2.7	52	16.1	0.00249
YDS1C 90S8	0.37	1.3	680	63.0	63.8	58.5	0.63	5.20	1.6	1.3	1.8	2.8	56	19.2	0.00335
YDS1C 90L8	0.55	1.9	680	66.0	67.2	62.3	0.65	7.70	1.6	1.3	1.8	3.0	56	21.8	0.00461
YDS1C 100LA8	0.75	2.4	710	66.0	67.5	62.5	0.67	10.10	1.7	1.3	2.1	3.5	59	27.9	0.00688
YDS1C 100LB8	1.1	3.2	710	72.0	72.8	67.7	0.69	14.80	1.7	1.3	2.1	3.5	59	32	0.00925
YDS1C 112M8	1.5	4.3	710	74.0	73.2	68.6	0.68	20.20	1.8	1.2	2.1	4.2	61	39.1	0.01552
YDS1C 132S8	2.2	6.0	720	75.0	75.5	71.1	0.71	29.20	2.0	1.2	2.0	5.5	64	58	0.03408
YDS1C 132M8	3	7.7	720	77.0	77.2	72.6	0.73	39.80	2.0	1.2	2.0	5.5	64	64	0.04522
YDS1C 160MA8	4	11.1	730	80.0	79.5	75.6	0.65	52.33	1.6	1.2	2.2	6.0	68	108	0.0762
YDS1C 160MB8	5.5	14.6	730	83.5	81.6	77.7	0.65	71.95	1.6	1.2	2.2	6.0	68	124	0.09095
YDS1C 160L8	7.5	19.6	730	85.0	82.8	79.5	0.65	98.12	1.6	1.2	2.2	6.0	68	136	0.10594
YDS1C 180L8	11	24.1	730	88.0	87.3	84.9	0.75	143.90	2.0	1.4	2.0	6.0	70	174	0.25695
YDS1C 200L8	15	29.7	730	89.0	89.3	88.0	0.82	196.20	1.6	1.3	2.2	7.0	73	220	0.36147
YDS1C 225S8	18.5	37.1	735	90.0	88.8	87.2	0.80	240.40	1.6	1.3	2.0	6.0	73	285	0.49078
YDS1C 225M8	22	43.9	735	90.5	90.4	89.1	0.80	285.90	1.6	1.3	2.0	6.0	73	310	0.58885
YDS1C 250M8	30	59.5	735	91.0	91.9	90.8	0.80	389.80	1.6	1.0	1.8	6.0	75	395	1.02008
YDS1C 280S8	37	74.8	740	91.5	91.2	90.5	0.78	477.50	1.9	1.2	2.0	6.5	76	523	1.88979
YDS1C 280M8	45	90.5	740	92.0	92.3	90.8	0.78	580.70	1.9	1.2	2.0	6.5	76	575	2.26008
YDS1C 315S8	55	106.9	740	92.8	92.5	91.2	0.80	709.80	2.0	1.3	2.0	6.5	82	842	3.89374
YDS1C 315M8	75	145.5	740	93.0	92.6	91.1	0.80	967.90	2.0	1.3	2.0	6.5	82	998.8	5.26785
YDS1C 315LA8	90	173.1	740	93.8	93.9	92.3	0.80	1161.50	2.0	1.3	2.0	6.5	82	1097	6.26411
YDS1C 315LB8	110	211.1	740	94.0	93.2	92.2	0.80	1419.60	2.0	1.3	2.0	6.5	82	1191	7.4415
YDS1C 355MA8	132	254.2	740	93.7	93.6	92.5	0.80	1703.50	1.8	1.3	2.0	6.5	90	1497	8.86978
YDS1C 355MB8	160	306.4	740	94.2	93.6	92.3	0.80	2064.90	1.8	1.3	2.0	6.5	90	1592	10.04236
YDS1C 355L8	200	381.8	740	94.5	93.1	92.5	0.80	2581.10	1.8	1.3	2.0	6.5	90	1752	12.28093



YDS2C Series IE2 Efficiency Motors Technical Data (at 50Hz)

Model	Output kW	Rated Current (A)	Speed (r/min)	Efficiency			Power Factor	Rated Torque (N/m)	Tst/Tn (Times)	Tmax/Tn (Times)	Tmin/Tn (Times)	Ist/In (Times)	Noise dB(A)	N.W (kgs)	Moment of Inertia (kg*m2)
				100%	75%	50%									
YDS2C 80A2	0.75	1.7	2840	77.4	77.5	73.8	0.81	2.52	2.5	2.1	2.6	6.0	67	14.5	0.00084
YDS2C 80B2	1.1	2.4	2880	79.6	80.5	78.6	0.82	3.65	2.5	1.8	2.6	7.5	67	16.5	0.00119
YDS2C 90S2	1.5	3.3	2880	81.3	81.9	81.0	0.82	4.97	2.5	1.8	2.6	7.0	72	18.5	0.00184
YDS2C 90L2	2.2	4.6	2880	83.2	83.6	82.5	0.83	7.30	2.5	1.4	2.6	7.5	72	22	0.00239
YDS2C 100L2	3	6.2	2890	84.6	85.5	84.0	0.83	9.91	2.5	2.0	2.8	7.5	76	33	0.0041
YDS2C 112M2	4	7.7	2910	85.8	85.3	82.7	0.88	13.13	2.5	1.8	2.8	9.5	77	41	0.00607
YDS2C 132SA2	5.5	10.4	2910	87.0	88.1	86.0	0.88	18.05	2.4	1.8	2.8	8.5	80	59.5	0.01251
YDS2C 132SB2	7.5	14.0	2920	88.1	89.0	87.3	0.88	24.53	2.5	1.8	2.8	10.0	80	64	0.01613
YDS2C 132MA2	9.2	17.1	2920	88.1	88.9	87.0	0.88	30.09	2.5	1.4	3.0	10.0	80	71	0.01758
YDS2C 160MA2	11	19.7	2930	89.4	89.5	89.0	0.90	35.85	2.5	1.4	2.8	8.5	86	113	0.04561
YDS2C 160MB2	15	26.6	2940	90.3	90.0	88.8	0.90	48.72	2.5	1.3	2.8	9.0	86	124	0.06206
YDS2C 160L2	18.5	32.6	2940	90.9	91.3	90.0	0.90	60.09	2.5	1.4	2.8	9.5	86	140	0.07528
YDS2C 180M2	22	38.6	2945	91.3	91.2	89.8	0.90	71.34	2.5	1.4	2.8	9.0	89	168	0.0811
YDS2C 200LA2	30	52.3	2945	92.0	92.1	90.9	0.90	97.30	2.0	1.3	2.5	7.0	92	235	0.14253
YDS2C 200LB2	37	64.2	2945	92.5	91.5	92.3	0.90	120.00	2.5	1.5	2.5	7.5	92	246	0.16466
YDS2C 225M2	45	77.7	2950	92.9	92.4	91.6	0.90	145.70	2.5	1.3	2.4	7.5	92	321	0.24906
YDS2C 250M2	55	94.6	2960	93.2	93.5	92.0	0.90	177.40	2.3	1.4	2.6	8.5	93	419	0.43328
YDS2C 280S2	75	128.2	2960	93.8	93.7	92.4	0.90	242.00	2.5	1.8	2.6	9.0	94	571	0.91866
YDS2C 280M2	90	153.4	2960	94.1	94.3	93.2	0.90	290.40	2.5	1.8	2.6	9.5	94	638	0.90716
YDS2C 315S2	110	187.1	2960	94.3	94.5	93.2	0.90	354.90	2.0	1.4	2.3	6.0	96	927	1.50928
YDS2C 315M2	132	223.8	2960	94.6	94.8	93.4	0.90	425.90	2.0	1.4	2.3	6.0	96	1006	1.67962
YDS2C 315LA2	160	270.7	2960	94.8	95.0	93.7	0.90	516.20	2.0	1.4	2.3	6.0	99	1060	1.87385
YDS2C 315LB2	200	337.6	2960	95.0	95.3	93.9	0.90	645.30	1.8	1.3	2.3	5.5	99	1130	2.13283
YDS2C 355MA2	220	371.4	2960	95.0	95.5	93.8	0.90	709.80	1.8	1.3	2.3	5.5	103	1590	2.95585
YDS2C 355MB2	250	422.0	2960	95.0	95.5	93.9	0.90	806.60	1.8	1.3	2.3	5.5	103	1650	3.14272
YDS2C 355LA2	280	472.7	2960	95.0	95.6	93.9	0.90	903.40	1.8	1.3	2.3	5.5	103	1715	3.47911
YDS2C 355LB2	315	531.8	2960	95.0	95.6	93.9	0.90	1016.30	1.8	1.3	2.3	5.5	103	1780	3.85287
YDS2C 80B4	0.75	1.9	1420	79.6	79.8	77.5	0.71	5.04	2.5	2.1	2.6	5.7	58	16	0.00128
YDS2C 90S4	1.1	2.8	1430	81.4	81.9	79.1	0.71	7.35	2.5	2.1	2.6	6.1	61	20	0.00315
YDS2C 90L4	1.5	3.5	1430	82.8	83.4	80.4	0.74	10.02	2.5	2.0	2.6	6.5	61	24	0.00411
YDS2C 100LA4	2.2	4.7	1430	84.3	85.5	83.6	0.80	14.69	2.2	2.0	2.6	6.6	64	34	0.00883
YDS2C 100LB4	3	6.3	1435	85.5	85.7	83.9	0.80	19.97	2.2	2.0	3.0	7.6	64	35	0.01039
YDS2C 112M4	4	8.2	1435	86.6	87.2	85.5	0.81	26.62	2.2	2.0	3.0	7.9	65	45	0.01369
YDS2C 132S4	5.5	10.9	1440	87.7	89.2	87.1	0.83	36.48	2.2	1.8	3.0	8.8	71	63	0.02966
YDS2C 132M4	7.5	14.7	1440	88.7	89.8	87.5	0.83	49.74	2.2	1.6	3.0	9.0	71	77.5	0.03981
YDS2C 132MB4	9.2	17.8	1440	88.7	89.9	87.5	0.84	61.01	2.2	1.6	3.0	8.8	71	85	0.047
YDS2C 160MA4	11	21.3	1440	89.8	91.7	91.0	0.83	72.95	2.5	1.6	2.5	7.1	75	119	0.0867
YDS2C 160L4	15	27.5	1450	90.6	91.3	90.5	0.87	98.79	2.5	1.6	2.5	8.9	75	146	0.11272
YDS2C 180M4	18.5	34.1	1450	91.2	91.8	90.8	0.86	121.80	2.5	1.6	2.8	8.6	76	161	0.14084
YDS2C 180L4	22	39.4	1460	91.6	92.2	91.6	0.88	143.90	2.5	1.6	2.8	8.1	76	176	0.16541
YDS2C 200L4	30	53.3	1460	92.3	92.8	91.9	0.88	196.20	2.5	2.1	3.0	8.5	79	242	0.27306
YDS2C 225S4	37	65.5	1470	92.7	93.9	92.6	0.88	240.40	2.2	1.3	2.3	7.6	81	315	0.50439
YDS2C 225M4	45	78.4	1480	93.1	94.2	92.8	0.89	290.40	2.2	1.3	2.3	7.7	81	340	0.59389
YDS2C 250M4	55	98.7	1480	93.5	94.4	93.6	0.86	354.90	2.5	1.5	2.5	8.6	83	420	0.7095
YDS2C 280S4	75	128.0	1480	94.0	94.9	93.7	0.90	484.00	2.5	2.0	2.5	9.0	86	580	1.5951
YDS2C 280M4	90	153.2	1480	94.2	94.9	93.7	0.90	580.70	2.5	2.0	2.5	8.7	86	650	1.89187
YDS2C 315S4	110	190.9	1480	94.5	94.8	93.2	0.88	709.80	2.0	1.3	2.8	7.4	93	938	3.09253
YDS2C 315M4	132	226.1	1480	94.7	95.0	93.6	0.89	851.80	2.0	1.3	2.6	7.0	93	1030	3.48345
YDS2C 315LA4	160	273.4	1480	94.9	95.0	93.5	0.89	1032.40	2.0	1.3	2.6	6.0	97	1106	3.9839
YDS2C 315LB4	200	341.1	1480	95.1	95.3	93.9	0.89	1290.50	2.0	1.3	2.3	6.0	97	1220	4.67201
YDS2C 355MA4	220	375.2	1480	95.1	95.9	94.1	0.89	1419.60	1.8	1.3	2.3	5.5	101	1560	6.872
YDS2C 355MB4	250	426.3	1480	95.1	95.8	94.0	0.89	1613.20	1.8	1.3	2.3	5.5	101	1600	7.6382
YDS2C 355LA4	280	477.5	1480	95.1	95.9	94.3	0.89	1806.80	1.8	1.3	2.3	5.5	101	1650	8.31927
YDS2C 355LB4	315	531.2	1480	95.1	96.0	94.2	0.90	2032.60	1.8	1.3	2.3	5.5	101	1700	9.08547
YDS2C 355LC4	355	598.7	1480	95.1	96.0	94.2	0.90	2290.70	1.8	1.3	2.3	5.5	101	1780	10.10708
YDS2C 90S6	0.75	2.2	935	75.9	76.4	73.8	0.64	7.66	2.0	1.8	2.2	5.0	57	19.6	0.0036
YDS2C 90L6	1.1	3.0	935	78.1	78.6	77.6	0.68	11.24	2.0	1.8	2.2	5.0	57	23.5	0.00536
YDS2C 100L6	1.5	3.7	940	79.8	80.2	78.3	0.73	15.24	1.6	1.6	2.2	5.0	61	32	0.00877
YDS2C 112M6	2.2	5.4	940	81.8	82.5	79.0	0.72	22.35	2.0	1.8	2.5	6.0	65	39	0.01468
YDS2C 132S6	3	6.9	940	83.3	84.0	82.2	0.75	30.48	1.6	1.5	2.2	6.0	69	54	0.03039
YDS2C 132MA6	4	9.2	950	84.6	85.1	83.5	0.74	40.21	2.0	1.6	2.5	6.0	69	65	0.03785
YDS2C 132MB6	5.5	12.5	950	86.0	86.8	85.4	0.74	55.29	2.0	1.8	2.5	7.0	69	66	0.0489
YDS2C 160M6	7.5	17.5	960	87.2	88.3	86.7	0.71	74.60	2.5	1.8	2.8	9.0	73	112	0.08726
YDS2C 160L6	11	23.9	960	88.7	88.6	87.5	0.75	109.40	2.5	1.4	2.8	9.0	73	132.6	0.12069
YDS2C 180L6	15	30.9	960	89.7	90.8	89.3	0.78	149.20	2.5	1.5	2.8	9.0	73	179	0.25695
YDS2C 200LA6	18.5	36.9	970	90.4	91.0	89.8	0.80	182.10	2.0	1.4	2.8	9.0	76	221.4	0.36147
YDS2C 200LB6	22	42.6	970	90.9	91.5	90.1	0.82	216.60	2.5	1.8	2.8	10.0	76	240.6	0.42742
YDS2C 225M6	30	55.6	975	91.7	92.3	91.2	0.85	293.80	2.5	1.5	2.2	9.0	76	335	0.67058
YDS2C 250M6	37	69.0	975	92.2	93.0	91.8	0.84	362.40	1.8	1.3	2.2	7.0	78	391.4	0.9243
YDS2C 280S6	45	82.4	980	92.7	92.7	91.9	0.85	438.50	2.3	1.4	2.3	8.5	80	514	1.78548
YDS2C 280MA6	55	99.2	980	93.1	93.2	92.2	0.86	536.00	2.5	1.7	2.8	9.0	80	584	2.20792
YDS2C 315S6	75	135.9	980	93.7	94.0	92.3	0.85	730.90	2.0	1.3	2.3	7.0	85	807	3.25976
YDS2C 315M6	90	162.6	980	94.0	94.6	92.3	0.85	877.00	2.0	1.3	2.3	7.0	85	913	3.90933
YDS2C 315LA6	110	198.1	980	94.3	94.8	92.4	0.85	1071.90	2.0	1.3	2.3	7.0	85	966	4.54331
YDS2C 315LB6	132	236.9	980	94.6	94.9	92.4	0.85	1286.30	2.0	1.3	2.3	6.5	85	1080	5.53956
YDS2C 355MA6	160	286.6	980	94.8	94.9	92.5	0.85	1559.20	2.0	1.3	2.3	6.5	92	1537	8.97637
YDS2C 355MB6	200	357.5	980	95.0	95.0	92.6	0.85	1949.00	2.0	1.3	2.3	6.5	92	1720	11.00175
YDS2C 355L6	250	446.9	980	95.0	95.2	92.6	0.85	2436.20	2.0	1.3	2.3	6.5	92	1880	13.56011



IE3 YDSC series Premium Efficiency Asynchronous Motor

YDS3C series IE3 Efficiency Motors Technical Data (at 50Hz)

Model	Output kW	Rated Current (A)	Speed (r/min)	Efficiency			Power Factor	Rated Torque (N/m)	Tst/Tn (Times)	Tmax/Tn (Times)	Tmin/Tn (Times)	Ist/In (Times)	Noise dB(A)	N.W (kgs)	Moment of Inertia (kg·m ²)
				100%	75%	50%									
YDS3C 80A2	0.75	1.7	2880	80.7	81.0	76.2	0.80	2.49	2.5	2.1	2.8	7.5	67	15.2	0.00093
YDS3C 80B2	1.1	2.4	2880	82.7	83.5	81.6	0.80	3.65	2.5	1.8	2.8	8.0	67	17.1	0.00128
YDS3C 90S2	1.5	3.1	2880	84.2	84.9	84.0	0.84	4.97	2.5	1.8	2.8	8.5	72	21.5	0.00224
YDS3C 90L2	2.2	4.5	2880	85.9	86.4	84.7	0.83	7.30	2.5	1.8	2.8	8.6	72	24.6	0.00279
YDS3C 100L2	3	5.7	2900	87.1	88.5	86.8	0.88	9.88	2.5	2.0	2.8	9.5	76	35.5	0.00496
YDS3C 112M2	4	7.3	2910	88.1	88.5	87.1	0.90	13.13	2.5	2.0	2.8	10.5	77	44.5	0.00744
YDS3C 132SA2	5.5	10.1	2910	89.2	90.2	88.6	0.88	18.05	2.5	2.0	3.0	10.0	80	63.2	0.01468
YDS3C 132SB2	7.5	13.5	2920	90.1	90.8	89.3	0.89	24.53	2.5	1.5	3.0	10.0	80	70.2	0.01903
YDS3C 132MA2	9.2	16.5	2920	90.6	91.2	89.5	0.89	30.09	2.5	1.5	3.0	10.0	80	76.8	0.02048
YDS3C 160MA2	11	19.3	2930	91.2	93.8	93.0	0.90	35.85	2.5	1.4	3.0	9.5	86	118	0.05178
YDS3C 160MB2	15	26.2	2940	91.9	93.1	92.9	0.90	48.72	2.5	1.4	3.0	10.0	86	128	0.06206
YDS3C 160L2	18.5	31.8	2940	92.4	93.5	93.3	0.91	60.09	2.5	1.4	3.0	9.5	86	144	0.07669
YDS3C 180M2	22	38.5	2945	92.7	94.1	93.6	0.89	71.34	2.5	1.4	3.0	9.0	89	183.4	0.09665
YDS3C 200LA2	30	52.1	2945	93.3	93.8	93.2	0.89	97.30	2.5	1.5	2.5	8.5	92	247	0.17351
YDS3C 200LB2	37	64.0	2945	93.7	94.4	94.2	0.89	120.00	2.5	1.5	2.5	8.5	92	268	0.20008
YDS3C 225M2	45	75.9	2950	94.0	94.6	94.1	0.91	145.70	2.5	1.4	2.5	8.5	92	369	0.34366
YDS3C 250M2	55	93.5	2960	94.3	94.5	93.1	0.90	177.40	2.5	1.4	2.6	10.0	93	428	0.44434
YDS3C 280S2	75	125.6	2960	94.7	94.9	93.7	0.91	242.00	2.5	1.8	2.6	10.0	94	587.3	0.82911
YDS3C 280M2	90	150.3	2960	95.0	95.2	94.3	0.91	290.40	2.5	1.8	2.6	10.0	94	655	0.98168
YDS3C 315S2	110	185.3	2960	95.2	95.5	94.6	0.90	354.90	2.0	1.4	2.3	7.0	96	980	1.70352
YDS3C 315M2	132	221.9	2960	95.4	95.5	94.7	0.90	425.90	2.0	1.4	2.3	7.0	96	1100	1.9386
YDS3C 315LA2	160	267.8	2960	95.8	95.8	94.5	0.90	516.20	2.0	1.4	2.3	7.0	99	1155	2.19758
YDS3C 315LB2	200	334.8	2960	95.8	96.0	94.7	0.90	645.30	2.0	1.4	2.3	7.0	99	1260	2.55368
YDS3C 355MA2	220	394.6	2960	95.8	96.2	94.8	0.84	709.80	2.0	1.5	2.3	6.5	103	1590	2.95858
YDS3C 355MB2	250	448.4	2960	95.8	96.2	94.8	0.84	806.60	2.0	1.5	2.3	6.5	103	1650	3.14272
YDS3C 355LA2	280	502.2	2960	95.8	96.2	94.8	0.84	903.40	2.0	1.5	2.3	6.5	103	1715	3.47911
YDS3C 355LB2	315	558.3	2960	95.8	96.2	94.8	0.85	1016.30	2.0	1.5	2.3	6.5	103	1780	3.85287
YDS3C 80B4	0.75	1.9	1420	82.5	82.8	80.6	0.69	5.04	2.8	2.2	2.8	6.3	58	18.2	0.00155
YDS3C 90S4	1.1	2.6	1430	84.1	84.6	83.2	0.72	7.35	2.8	2.2	2.8	6.8	61	23	0.00372
YDS3C 90L4	1.5	3.6	1430	85.3	86.1	85.2	0.70	10.02	2.8	2.2	3.0	7.3	61	26.3	0.00469
YDS3C 100LA4	2.2	4.5	1430	86.7	87.8	85.2	0.81	14.69	2.8	2.2	3.0	8.0	64	35.5	0.00922
YDS3C 100LB4	3	6.3	1435	87.7	88.0	85.9	0.78	19.97	2.5	2.2	3.0	8.2	64	38.5	0.01195
YDS3C 112M4	4	8.0	1440	88.6	88.9	87.5	0.82	26.53	2.5	2.2	3.0	8.6	65	47	0.01545
YDS3C 132S4	5.5	10.7	1440	89.6	90.9	88.9	0.83	36.48	2.5	1.8	3.0	9.0	71	68.3	0.03397
YDS3C 132M4	7.5	14.1	1440	90.4	91.3	91.2	0.85	49.74	2.5	1.6	3.0	9.0	71	79	0.04412
YDS3C 132MB4	9.2	17.2	1440	90.9	91.8	90.5	0.85	61.01	2.5	1.6	3.0	9.0	71	87.5	0.047
YDS3C 160M4	11	20.7	1450	91.4	92.2	91.7	0.84	72.45	2.5	1.3	3.0	10.0	75	127	0.10355
YDS3C 160L4	15	27.3	1450	92.1	92.9	92.2	0.86	98.80	2.5	1.3	2.8	8.5	75	160	0.1375
YDS3C 180M4	18.5	33.5	1460	92.6	93.6	93.0	0.86	121.00	2.5	1.8	3.0	9.0	76	169.4	0.1553
YDS3C 180L4	22	39.2	1460	93.0	93.7	92.9	0.87	143.90	2.5	1.8	3.0	10.0	76	196	0.19433
YDS3C 200L4	30	57.1	1470	93.6	93.7	93.2	0.81	194.90	2.5	1.8	2.8	9.0	79	252	0.29441
YDS3C 225S4	37	65.4	1470	93.9	95.2	94.3	0.87	240.40	2.5	1.4	2.5	9.2	81	324.5	0.57838
YDS3C 225M4	45	79.3	1470	94.2	95.2	94.5	0.87	292.30	2.5	1.5	2.5	9.0	81	352.9	0.65309
YDS3C 250M4	55	95.4	1470	94.6	95.2	94.5	0.88	357.30	2.5	1.8	2.5	8.5	83	427.4	0.76504
YDS3C 280S4	75	131.0	1480	95.0	95.1	94.8	0.87	484.00	2.5	1.8	2.8	10.0	86	673.3	1.99603
YDS3C 280M4	90	160.5	1480	95.2	95.1	95.0	0.85	580.70	2.5	1.8	2.8	10.0	86	692	2.18345
YDS3C 315S4	110	189.1	1480	95.4	95.7	94.6	0.88	709.80	2.2	1.5	2.6	9.0	93	1027	3.71808
YDS3C 315M4	132	226.5	1480	95.6	95.8	95.0	0.88	851.80	2.2	1.5	2.6	9.0	93	1155	4.29667
YDS3C 315LA4	160	273.9	1480	95.8	96.0	95.1	0.88	1032.40	2.2	1.5	2.6	9.0	97	1240	5.1099
YDS3C 315LB4	200	337.9	1480	96.0	96.2	95.3	0.89	1290.50	2.2	1.5	2.6	9.0	97	1400	6.17334
YDS3C 355MA4	220	371.7	1480	96.0	96.2	95.3	0.89	1419.60	2.0	1.3	2.3	8.0	101	1560	7.04227
YDS3C 355MB4	250	422.3	1480	96.0	96.3	95.4	0.89	1613.20	2.0	1.3	2.3	8.0	101	1600	7.6382
YDS3C 355LA4	280	473.0	1480	96.0	96.4	95.4	0.89	1806.80	2.0	1.3	2.3	8.0	101	1650	8.31927
YDS3C 355LB4	315	532.1	1480	96.0	96.3	95.5	0.89	2032.60	2.0	1.3	2.3	8.0	101	1700	9.3408
YDS3C 90S6	0.75	2.1	935	78.9	79.6	77.2	0.67	7.66	2.0	1.8	2.2	5.0	57	21.5	0.00435
YDS3C 90L6	1.1	3.0	940	81.0	81.5	80.2	0.66	11.18	2.3	1.8	2.2	5.2	57	25.5	0.00611
YDS3C 100L6	1.5	3.6	940	82.5	83.0	81.6	0.74	15.24	2.0	1.7	2.2	5.2	61	33.5	0.00972
YDS3C 112M6	2.2	5.4	940	84.3	85.0	83.2	0.70	22.35	2.0	1.8	2.2	6.2	65	40	0.01637
YDS3C 132S6	3	6.8	940	85.6	86.1	84.5	0.74	30.48	2.0	1.7	2.2	6.0	69	59	0.03223
YDS3C 132MA6	4	9.0	950	86.8	87.6	85.2	0.74	40.21	2.0	1.6	2.5	7.0	69	75.5	0.04338
YDS3C 132MB6	5.5	12.7	950	88.0	88.8	86.9	0.71	55.29	2.3	1.8	2.5	7.5	69	76.3	0.05443
YDS3C 160M6	7.5	16.2	960	89.1	90.3	88.0	0.75	74.60	2.3	1.4	2.8	7.5	73	112	0.08726
YDS3C 160L6	11	23.1	960	90.3	91.2	88.5	0.76	109.40	2.5	1.4	2.8	8.5	73	134	0.13544
YDS3C 180L6	15	30.1	960	91.2	92.0	90.3	0.79	149.20	2.5	1.4	2.8	8.0	73	184.5	0.27973
YDS3C 200LA6	18.5	36.4	970	91.7	92.3	90.6	0.80	182.10	2.5	1.4	2.8	9.5	76	231	0.38345
YDS3C 200LB6	22	42.5	970	92.2	93.0	91.3	0.81	216.60	2.5	1.5	2.8	10.0	76	249	0.44941
YDS3C 225M6	30	53.0	975	92.9	93.8	90.9	0.88	293.80	1.8	1.5	2.2	7.0	76	339	0.67058
YDS3C 250M6	37	67.3	975	93.3	94.0	91.8	0.85	362.40	1.8	1.3	2.0	7.0	78	399.4	0.99243
YDS3C 280S6	45	83.5	980	93.7	94.6	92.7	0.83	438.50	2.5	1.8	2.8	10.0	80	551	2.20274
YDS3C 280MA6	55	99.3	980	94.1	95.0	93.4	0.85	536.00	2.5	1.8	2.8	10.0	80	624.3	2.57302
YDS3C 315S6	75	139.6	980	94.6	94.8	93.2	0.82	730.90	2.0	1.3	2.3	7.5	85	860	3.80317
YDS3C 315M6	90	166.9	980	94.9	95.0	93.4	0.82	877.00	2.0	1.3	2.3	7.5	85	970	4.45274
YDS3C 315LA6	110	203.6	980	95.1	95.4	94.0	0.82	1071.90	2.0	1.3	2.3	7.5	85	1070	5.53956
YDS3C 315LB6	132	243.6	980	95.4	95.7	94.2	0.82	1286.30	2.0	1.3	2.3	7.5	85	1196	6.62638
YDS3C 355MA6	160	294.6	980	95.6	95.8	94.3	0.82	1559.20	2.0	1.3	2.3	7.5	92	1537	8.97637
YDS3C 355MB6	200	367.5	980	95.8	95.8	94.3	0.82	1949.00	2.0	1.3	2.3	7.5	92	1720	11.00175
YDS3C 355LA6	220	404.2	980	95.8	96.0	94.2	0.82	2143.90	2.0	1.3	2.3	7.5	92	1800	11.64134
YDS3C 355LB6	250	459.3	980	95.8	96.0	94.3	0.82	2436.20	2.0	1.3	2.3	7.5	92	1880	13.56011