



NEMA series Single-Phase TEFC Electric Motors

Features

- Continuous Duty 40°C Ambient
- TEFC (Totally Enclosed Fan Cooled)
- Class F Insulation With Class B Temp Rise
- Aluminum Alloy Frame / Cast Iron Frames
- NEMA Design L
- High Starting Torque and Low Starting Current
- Ball Bearings
- IP55 Protection
- Stainless Steel Nameplate
- Capacitor Start Induction Run
- Capacitor Start / Capacitor Run
- PSC (Permanent Split Capacitor) Motors

Applications

- Commercial Pumps
- Swimming Pool Pumps
- Fans
- Conveyors
- Air Conditioning Equipment A.K.A HVAC
- Small Machine Tools
- Blowers
- Augers
- Equipment Requiring Direct Drive and High Starting Torque

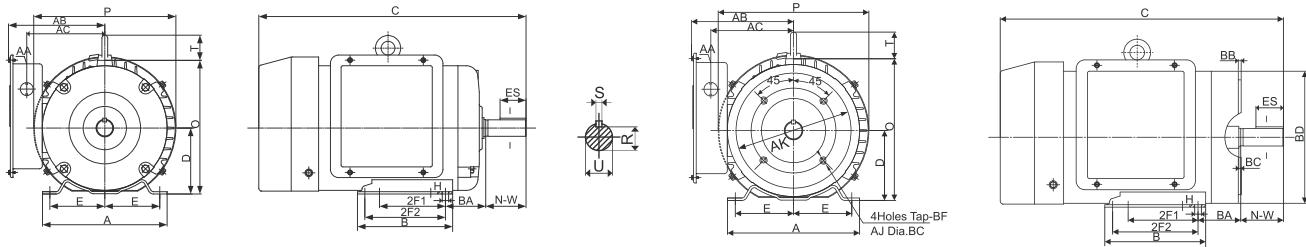

Overall Installation Dimension

| Frame | General | | | | | | | | | | | | | | | Shaft | | | | C-FACE | | | | | | |
|-------|---------|------|------|----------|------|------|------|------|------|------|------|------|-------|------|-------|-------|-------|-------|-------|--------|-------|------|-------|-------|-----|--------|
| | A | B | D | H | BA | E | 2F1 | 2F2 | AA | AB | AC | T | O | O* | P | N-W | U | S | R | ES | BC | BB | BD | AJ | AK | Tap-BF |
| 48 | 5.75 | 4.00 | 3.00 | 0.34slot | 2.50 | 2.12 | 2.75 | - | 0.88 | 5.15 | 4.00 | - | 7.45 | 7.80 | 6.40 | 1.50 | 0.500 | Flat | 0.453 | - | -0.19 | 0.16 | 5.625 | 3.75 | 3 | 1/4-20 |
| 56 | 6.50 | 4.15 | 3.50 | 0.34slot | 2.75 | 2.44 | 3.00 | - | 0.88 | 5.65 | 4.45 | - | 7.75 | 8.70 | 7.20 | 1.88 | 0.625 | 0.188 | 0.517 | 1.41 | -0.19 | 0.16 | 6.45 | 5.875 | 4.5 | 3/8-16 |
| 56H | 6.50 | 6.00 | 3.50 | 0.34slot | 2.75 | 2.44 | 3.00 | 5.00 | 0.88 | 5.65 | 4.45 | - | 7.75 | 8.70 | 7.20 | 1.88 | 0.625 | 0.188 | 0.517 | 1.41 | -0.19 | 0.16 | 6.45 | 5.875 | 4.5 | 3/8-16 |
| 143T | 6.50 | 6.00 | 3.50 | 0.34 | 2.25 | 2.75 | 4.00 | 5.00 | 0.88 | 5.65 | 4.45 | - | 7.75 | 8.70 | 7.20 | 2.25 | 0.88 | 0.188 | 0.771 | 1.41 | +0.12 | 0.16 | 6.45 | 5.875 | 4.5 | 3/8-16 |
| 145T | 6.50 | 6.00 | 3.50 | 0.34 | 2.25 | 2.75 | 4.00 | 5.00 | 0.88 | 5.65 | 4.45 | - | 7.75 | 8.70 | 7.20 | 2.25 | 0.88 | 0.188 | 0.771 | 1.41 | +0.12 | 0.16 | 6.45 | 5.875 | 4.5 | 3/8-16 |
| 182T | 8.50 | 6.50 | 4.50 | 0.41 | 2.75 | 3.75 | 4.50 | 5.50 | 1.10 | 6.70 | 5.40 | 1.75 | 9.10 | - | 9.70 | 2.75 | 1.125 | 0.25 | 0.986 | 1.78 | +0.12 | 0.25 | 9.00 | 7.250 | 8.5 | 1/2-13 |
| 184T | 8.50 | 6.50 | 4.50 | 0.41 | 2.75 | 3.75 | 4.50 | 5.50 | 1.10 | 6.70 | 5.40 | 1.75 | 9.10 | - | 9.70 | 2.75 | 1.13 | 0.25 | 0.986 | 1.78 | +0.12 | 0.25 | 9.00 | 7.250 | 8.5 | 1/2-13 |
| 213T | 10.45 | 8.50 | 5.25 | 0.41 | 3.50 | 4.25 | 5.50 | 7.00 | 1.10 | 7.50 | 6.25 | 1.75 | 10.65 | - | 11.35 | 3.38 | 1.375 | 0.312 | 1.201 | 2.41 | +0.25 | 0.25 | 9.00 | 7.250 | 8.5 | 1/2-13 |
| 215T | 10.45 | 8.50 | 5.25 | 0.41 | 3.50 | 4.25 | 5.50 | 7.00 | 1.10 | 7.50 | 6.25 | 1.75 | 10.65 | - | 11.35 | 3.38 | 1.375 | 0.312 | 1.201 | 2.41 | +0.25 | 0.25 | 9.00 | 7.250 | 8.5 | 1/2-13 |

PSC(Permanent Split Capacitor) TEFC Motors Technical Data

| HP | Speed (r/min) | NEMA Frame | Code | Full Load Data | | | Locked Rotor Current at 230V(A) | Torque | |
|------|---------------|------------|------|----------------|--------|--------------------|---------------------------------|--------------------|------------------|
| | | | | Torque LB-FT | Eff(%) | Current at 230V(A) | | Locked Rotor LB-FT | Break Down LB-FT |
| 1/12 | 3450 | 48 | K | 0.12 | 58.0 | 0.50 | 3 | 0.06 | 0.20-0.25 |
| 1/12 | 1725 | 48 | K | 0.24 | 55.0 | 0.53 | 3 | 0.12 | 0.40-0.50 |
| 1/8 | 3450 | 48 | L | 0.18 | 60.0 | 0.72 | 5 | 0.09 | 0.25-0.30 |
| 1/8 | 1725 | 48 | L | 0.36 | 57.0 | 0.76 | 5 | 0.18 | 0.50-0.65 |
| 1/6 | 3450 | 48 | S | 0.24 | 63.0 | 0.92 | 12 | 0.12 | 0.30-0.40 |
| 1/6 | 1725 | 48 | S | 0.48 | 60.0 | 0.97 | 12 | 0.24 | 0.65-1.00 |
| 1/4 | 3450 | 48 | P | 0.36 | 66.0 | 1.30 | 15 | 0.15 | 0.40-0.60 |
| 1/4 | 1725 | 48 | P | 0.72 | 64.0 | 1.35 | 15 | 0.30 | 1.00-1.31 |
| 1/3 | 3450 | 48 | N | 0.51 | 68.0 | 1.80 | 18 | 0.21 | 0.60-0.90 |
| 1/3 | 1725 | 48 | N | 1.02 | 67.0 | 1.85 | 18 | 0.42 | 1.31-2.97 |
| 1/2 | 3450 | 48 | N | 0.75 | 71.0 | 2.50 | 25 | 0.30 | 0.90-1.40 |
| 1/2 | 1725 | 48 | N | 1.50 | 70.0 | 2.60 | 25 | 0.60 | 1.97-2.97 |
| 3/4 | 3450 | 56 | M | 1.12 | 73.0 | 3.60 | 35 | 0.45 | 1.40-1.90 |
| 3/4 | 1725 | 56 | M | 2.24 | 72.0 | 3.70 | 35 | 0.90 | 2.97-3.97 |
| 1 | 3460 | 56H | M | 1.52 | 74.0 | 4.80 | 45 | 0.55 | 1.90-2.90 |
| 1 | 1730 | 56H | M | 3.04 | 73.0 | 4.90 | 45 | 1.10 | 3.97-5.94 |
| 1 | 3460 | 143T | M | 1.52 | 74.0 | 4.80 | 45 | 0.55 | 1.90-2.90 |
| 1 | 1730 | 143T | M | 3.04 | 73.0 | 4.90 | 45 | 1.10 | 3.97-5.94 |
| 1.5 | 3460 | 56H | J | 2.24 | 76.0 | 6.70 | 50 | 0.75 | 2.90-3.90 |
| 1.5 | 1730 | 56H | J | 4.48 | 75.0 | 6.90 | 50 | 1.50 | 5.94-7.88 |
| 1.5 | 3460 | 143T | J | 2.24 | 76.0 | 6.70 | 50 | 0.75 | 2.90-3.90 |
| 1.5 | 1730 | 145T | J | 4.48 | 75.0 | 6.90 | 50 | 1.50 | 5.94-7.88 |
| 2 | 3460 | 56H | J | 3.05 | 77.0 | 9.10 | 65 | 0.93 | 3.90-5.00 |
| 2 | 1730 | 56H | J | 6.10 | 77.0 | 9.20 | 65 | 1.86 | 7.88-9.88 |
| 2 | 3460 | 145T | J | 3.05 | 77.0 | 9.10 | 65 | 0.93 | 3.90-5.00 |
| 2 | 1740 | 145T | J | 6.10 | 77.0 | 9.20 | 65 | 1.86 | 7.88-9.88 |

NEMA series Single-Phase TEFC Electric Motors



Capacitor Start / Capacitor Run TEFC Motors Technical Data

| HP | Speed (r/min) | NEMA Frame | Code | Full Load Data | | | Locked Rotor Current at 230V(A) | Torque | |
|-----|---------------|------------|------|----------------|--------|--------------------|---------------------------------|--------------------|------------------|
| | | | | Torque LB-FT | Eff(%) | Current at 230V(A) | | Locked Rotor LB-FT | Break Down LB-FT |
| 1/4 | 3450 | 48 | P | 0.36 | 66.0 | 1.3 | 15 | 1.32 | 0.72-1.03 |
| 1/4 | 1725 | 48 | P | 0.72 | 64.0 | 1.4 | 15 | 2.90 | 1.34-1.97 |
| 1/3 | 3450 | 48 | N | 0.51 | 68.0 | 1.8 | 18 | 1.63 | 1.03-1.34 |
| 1/3 | 1725 | 48 | N | 1.02 | 67.0 | 1.9 | 18 | 3.60 | 1.97-2.53 |
| 1/3 | 3450 | 56 | N | 0.51 | 68.0 | 1.8 | 18 | 1.63 | 1.03-1.34 |
| 1/3 | 1725 | 56 | N | 1.02 | 67.0 | 1.9 | 18 | 3.60 | 1.97-2.53 |
| 1/2 | 3450 | 48 | N | 0.75 | 71.0 | 2.5 | 25 | 2.32 | 1.34-1.97 |
| 1/2 | 1725 | 48 | N | 1.50 | 70.0 | 2.6 | 25 | 5.30 | 2.53-3.63 |
| 1/2 | 3450 | 56 | N | 0.75 | 71.0 | 2.5 | 25 | 2.32 | 1.34-1.97 |
| 1/2 | 1725 | 56 | N | 1.50 | 70.0 | 2.6 | 25 | 5.30 | 2.53-3.63 |
| 3/4 | 3450 | 48 | M | 1.12 | 73.0 | 3.6 | 35 | 3.13 | 1.97-2.75 |
| 3/4 | 1725 | 48 | M | 2.24 | 72.0 | 3.7 | 35 | 7.50 | 3.63-5.26 |
| 3/4 | 3450 | 56 | M | 1.12 | 73.0 | 3.6 | 35 | 3.13 | 1.97-2.75 |
| 3/4 | 1725 | 56 | M | 2.24 | 72.0 | 3.7 | 35 | 7.50 | 3.63-5.26 |
| 1 | 3460 | 56H | M | 1.52 | 74.0 | 4.8 | 45 | 3.82 | 2.75-3.63 |
| 1 | 1730 | 56H | M | 3.04 | 73.0 | 4.9 | 45 | 9.00 | 5.26-6.8 |
| 1 | 3460 | 143T | M | 1.52 | 74.0 | 4.8 | 45 | 3.82 | 2.75-3.63 |
| 1 | 1730 | 143T | M | 3.04 | 73.0 | 4.9 | 45 | 9.00 | 5.26-6.8 |
| 1.5 | 3460 | 56H | J | 2.24 | 76.0 | 6.7 | 50 | 4.50 | 3.63-4.6 |
| 1.5 | 1730 | 56H | J | 4.48 | 75.0 | 6.9 | 50 | 12.50 | 6.8-10.1 |
| 1.5 | 3460 | 143T | J | 2.24 | 76.0 | 6.7 | 50 | 4.50 | 3.63-4.6 |
| 1.5 | 1730 | 145T | J | 4.48 | 75.0 | 5.9 | 50 | 12.50 | 6.8-10.1 |
| 2 | 3460 | 56H | J | 3.05 | 77.0 | 9.1 | 65 | 5.50 | 4.5-6 |
| 2 | 1730 | 56H | J | 6.10 | 77.0 | 9.2 | 65 | 16.00 | 10.1-13.0 |
| 2 | 3460 | 145T | J | 3.05 | 77.0 | 9.1 | 65 | 5.60 | 4.50-6.0 |
| 2 | 1730 | 145T | J | 6.10 | 77.0 | 9.2 | 65 | 16.00 | 10.1-13.0 |
| 3 | 3460 | 182T | H | 4.48 | 79.0 | 13.0 | 90 | 7.50 | 6.0-6.80 |
| 3 | 1740 | 182T | H | 8.91 | 80.0 | 12.9 | 90 | 22.00 | 13.0-19.0 |
| 5 | 3460 | 184T | G | 7.53 | 81.0 | 20.9 | 135 | 11.00 | 8.60-13.50 |
| 5 | 1740 | 184T | G | 14.98 | 82.0 | 21.0 | 135 | 33.00 | 19.0-30.0 |
| 7.5 | 3460 | 213T | G | 11.20 | 81.0 | 30.8 | 200 | 16.00 | 13.50-20.0 |
| 7.5 | 1740 | 213T | G | 22.26 | 82.0 | 31.0 | 200 | 45.00 | 30.0-45.0 |
| 10 | 3460 | 215T | G | 15.26 | 82.0 | 41.5 | 260 | 21.00 | 20.0-27.0 |
| 10 | 1740 | 215T | G | 30.36 | 83.0 | 41.8 | 260 | 52.00 | 45.0-60.0 |

Capacitor Start Induction Run TEFC Motors Technical Data

| HP | Speed (r/min) | NEMA Frame | Code | Full Load Data | | | Locked Rotor Current at 230V(A) | Torque | |
|-----|---------------|------------|------|----------------|--------|--------------------|---------------------------------|--------------------|------------------|
| | | | | Torque LB-FT | Eff(%) | Current at 230V(A) | | Locked Rotor LB-FT | Break Down LB-FT |
| 1/6 | 3450 | 48 | S | 0.24 | 55.0 | 1.5 | 12 | 0.94 | 0.54-0.72 |
| 1/6 | 1725 | 48 | S | 0.48 | 54.0 | 1.6 | 12 | 2.10 | 1.03-1.34 |
| 1/4 | 3450 | 48 | P | 0.36 | 57.0 | 2.1 | 15 | 1.32 | 0.72-1.03 |
| 1/4 | 1725 | 48 | P | 0.72 | 56.0 | 2.2 | 15 | 2.90 | 1.34-1.97 |
| 1/3 | 3450 | 48 | N | 0.51 | 58.0 | 2.6 | 18 | 1.63 | 1.03-1.34 |
| 1/3 | 1725 | 48 | N | 1.02 | 57.0 | 2.8 | 18 | 3.60 | 1.97-2.53 |
| 1/3 | 3450 | 56 | N | 0.51 | 58.0 | 2.6 | 18 | 1.63 | 1.03-1.34 |
| 1/3 | 1725 | 56 | N | 1.02 | 57.0 | 2.8 | 18 | 3.60 | 1.97-2.53 |
| 1/2 | 3450 | 48 | N | 0.75 | 60.0 | 3.6 | 25 | 2.32 | 1.34-1.97 |
| 1/2 | 1725 | 48 | N | 1.50 | 59.0 | 3.8 | 25 | 5.30 | 2.53-3.63 |
| 1/2 | 3450 | 56 | N | 0.75 | 60.0 | 3.6 | 25 | 2.32 | 1.34-1.97 |
| 1/2 | 1725 | 56 | N | 1.50 | 59.0 | 3.8 | 25 | 5.30 | 2.53-3.63 |
| 3/4 | 3450 | 56H | M | 1.12 | 63.0 | 5.0 | 35 | 3.13 | 1.97-2.75 |
| 3/4 | 1725 | 56H | M | 2.24 | 62.0 | 5.3 | 35 | 7.50 | 3.63-5.26 |
| 1 | 3460 | 56H | M | 1.52 | 65.0 | 6.4 | 45 | 3.82 | 2.75-3.63 |
| 1 | 1730 | 56H | M | 3.04 | 64.0 | 6.7 | 45 | 9.00 | 5.26-6.8 |
| 1 | 3460 | 143T | M | 1.52 | 65.0 | 6.4 | 45 | 3.82 | 2.75-3.63 |
| 1 | 1730 | 143T | M | 3.04 | 64.0 | 6.7 | 45 | 9.00 | 5.26-6.8 |
| 1.5 | 3460 | 56H | J | 2.24 | 68.0 | 8.8 | 50 | 4.50 | 3.63-4.6 |
| 1.5 | 1730 | 56H | J | 4.48 | 67.0 | 9.3 | 50 | 12.50 | 6.8-10.1 |
| 1.5 | 3460 | 145T | J | 2.24 | 68.0 | 8.8 | 50 | 4.50 | 3.63-4.6 |
| 1.5 | 1730 | 145T | J | 4.48 | 67.0 | 9.3 | 50 | 12.50 | 6.8-10.1 |
| 2 | 3460 | 182T | J | 3.05 | 70.0 | 11.5 | 65 | 5.60 | 4.50-6.0 |
| 2 | 1730 | 182T | J | 6.10 | 69.0 | 12.1 | 65 | 16.00 | 10.1-13.0 |
| 3 | 3460 | 184T | H | 4.48 | 75.0 | 15.7 | 90 | 7.50 | 6.0-6.80 |
| 3 | 1740 | 184T | H | 8.91 | 74.0 | 16.3 | 90 | 22.00 | 13.0-19.0 |